



Priorslee Road

• GUIDE PRICE £550,000

- Four Bedrooms
- En Suite
- Jack & Jill Bathroom
- Conservatory
- Ample Off Street Parking
- Oil-Fired Central Heating
- No Upward Chain





A spacious and characterful 3-4 bedroom farmhouse offering the perfect blend of rustic charm and modern living. Situated on the outskirts of Shifnal, this property boasts beautiful gardens, ample living space, and excellent transport connections

DESCRIPTION

Welcome to Blythbury Farm House, a charming semi-detached character property offering the perfect blend of period charm and modern living. Situated on the peaceful outskirts of Shifnal, this rural family home boasts 3-4 spacious bedrooms, including a principal bedroom with an en-suite bathroom and additional bedrooms served by a Jack and Jill bathroom.

The ground floor features a large dining room, a dual-aspect lounge with original timber shutters, and a generously sized dining kitchen with feature ceiling timbers. A bright conservatory extends from the kitchen, providing an ideal space for entertaining with views over the expansive lawned gardens, which are perfect for family activities.

The property is set within the beautiful Shropshire countryside and benefits from excellent transport links, with easy access to the M54 and Shifnal rail station connecting you to Shrewsbury, Birmingham, and



Thomas Dainty
 Consultant
 02038790742
 thomas.dainty@hardinggreen.com

Blythbury Farmhouse, Shifnal
 Approximate Gross Internal Area
 2091 Sq Ft/194 Sq M

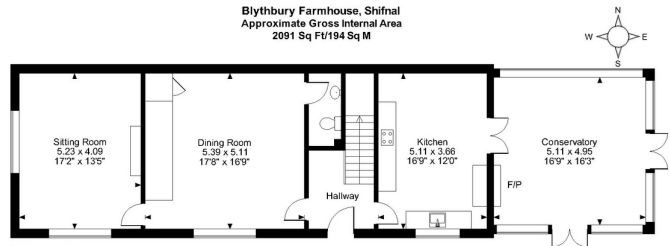

Ground Floor



First Floor

FOR ILLUSTRATIVE PURPOSES ONLY - NOT TO SCALE
 The position & size of doors, windows, appliances and other features are approximate only.
 © ehouse. Unauthorised reproduction prohibited. Drawing ref. dig861503/KRA



FIND OUT MORE

Important Notice. We would like to inform prospective purchasers that these sales particulars have been prepared as a general guide only. A detailed survey has not been carried out, nor the services, appliances and fittings tested. Room sizes should not be relied upon for furnishing purposes and are approximate. If floor plans are included, they are for guidance only and illustration purposes only and may not be to scale. If there are any important matters likely to affect your decision to buy, please contact us before viewing the property.