



Sloane Street

KNIGHTSBRIDGE • £6,000 PER MONTH

Elegant 2-bedroom, 2-bathroom, 808 sqft Sloane Street apartment with a chic bar area, abundant natural light, and the added convenience of an elevator and dedicated porter

DESCRIPTION

Nestled on prestigious Sloane Street, this exquisite 2-bedroom, 2-bathroom apartment offers an exceptional blend of luxury and convenience. Spanning over 800sqft, the well-appointed interiors are fully furnished, creating a sophisticated and comfortable living space. The sixth-floor vantage point not only provides breathtaking views but also ensures an abundance of natural light throughout the day. Elevator access enhances convenience, making every floor easily accessible, complemented by the presence of a dedicated porter for added security and assistance.

The apartment's charm extends beyond its bedrooms and bathrooms. A thoughtfully designed small bar area adds a touch of elegance, perfect for entertaining guests or unwinding after a busy day. The contemporary design elements harmonise with classic touches, creating a timeless ambience.

Location is key, and this residence places you in the heart of London's most iconic attractions. A short stroll takes you to the world-renowned Harrods, while the green expanse of Hyde Park beckons for leisurely walks and outdoor activities. The fashion and culinary delights of Harvey Nichols are within easy reach, ensuring that the best of London living is at your doorstep.

TERMS

Price: £6,000 per month

Local Authority: Kensington & Chelsea

Council Tax:

Energy Rating:









APPROXIMATE FLOOR AREA = 808 SQ FT / 75.06 SQ M

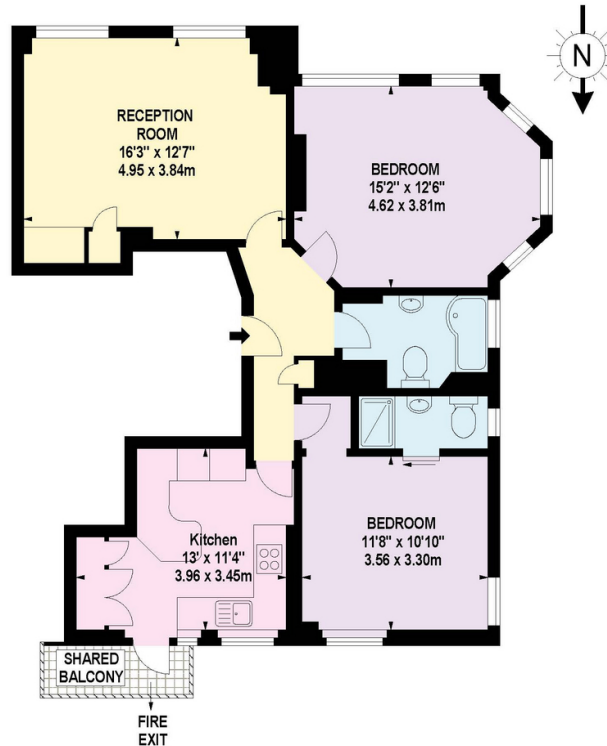

SIXTH FLOOR
808 SQ FT / 75.06 SQ M

Illustration For Identification Purposes Only. Not To Scale
* As Defined by RICS - Code of Measuring Practice
© International Floorplans.
Tel 0094 115 345968
www.ifpl.uk



Benjamin Scrace

Partner

0208 176 2000

benjamin.scrace@hardinggreen.com

Important Notice. We would like to inform prospective tenants that these lettings particulars have been prepared as a general guide only. A detailed survey has not been carried out, nor the services, appliances and fittings tested(remove). Room sizes should not be relied upon for furnishing purposes and are approximate. If floor plans are included, they are for guidance only and illustration purposes only and may not be to scale. If there are any important matters likely to affect your decision to rent, please contact us before viewing the property.



FIND OUT MORE