



# Wenlock Road

ANGEL • £3,500 PER MONTH

## Discover Tranquility in London: Fully furnished two-bedroom canal-side oasis just minutes from central hotspots, including Liverpool Street, Bank, Kings Cross, Old Street, Angel and Farringdon stations

- Fully Furnished
- Large Balcony
- Student Friendly
- Pets Considered
- Concierge Weekdays 9am - 6pm
- Quiet Location

### DESCRIPTION

Escape the hustle of London to embrace the serenity of a canal-side haven, just a brisk 10-minute (or less) bike ride from major central London destinations, including Liverpool Street, Bank, Kings Cross, Old Street, Angel, and Farringdon Stations.

This peaceful retreat boasts a unique location with no through traffic, nestled between the scenic Shepherdess Walk Park and the tranquil waters of Regent's Canal.

Inside, you'll find a world of convenience. The concierge is at your service from 9 am to 6 pm, Monday to Friday. This modern abode is fully furnished, recently repainted, and refreshed to ensure your comfort. Plus, there's a secure storage for your bike included!

Security is paramount here, with triple-door access to the building and 24-hour camera surveillance both inside and outside.

Getting around is a breeze with proximity to City Road and Old Street Station. And when it's time for food, drinks, and entertainment, you're just minutes away from Islington High Street, Shoreditch, Hackney, and Haggerston.















**Cube Building,  
Wenlock Road, N1**  
Approx. Gross Internal Area \*  
685 Ft<sup>2</sup> - 63.64 M<sup>2</sup>

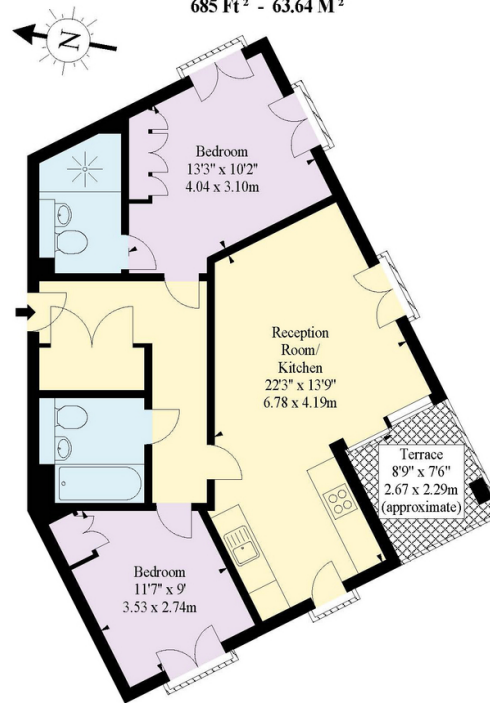

**Fifth Floor**

**Illustration For Identification Purposes Only. Not To Scale**

\* As Defined by RICS - Code of Measuring Practice  
© International Floorplans.  
Tel 0094 115 345958  
www.ifpl.lk



**Benjamin Scrace**

Partner

**0208 176 2000**

benjamin.scrace@hardinggreen.com

Important Notice. We would like to inform prospective tenants that these lettings particulars have been prepared as a general guide only. A detailed survey has not been carried out, nor the services, appliances and fittings tested( remove). Room sizes should not be relied upon for furnishing purposes and are approximate. If floor plans are included, they are for guidance only and illustration purposes only and may not be to scale. If there are any important matters likely to affect your decision to rent, please contact us before viewing the property.



FIND OUT MORE