



Tythe Barn Cottages | | Lazonby | CA10 1BG

Price Guide £169,000



david britton
ESTATES

Key features

- End terraced Cottage
- Three bedrooms
- Livingroom
- Kitchen diner
- Terraced garden
- Yard
- Converted Garage and carport
- Village centre location
- Eden Valley

Description

A gorgeous three bedroomed end terraced cottage right in the very heart of Lazonby Village, one of the Eden Valley's most popular locations.

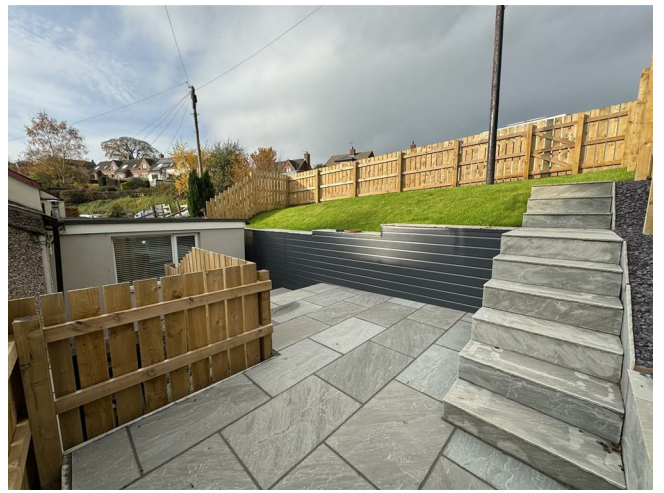

Directions



Floor plans

GROUND FLOOR
APPROX. 27.7 SQ. METRES (297.6 SQ. FEET)

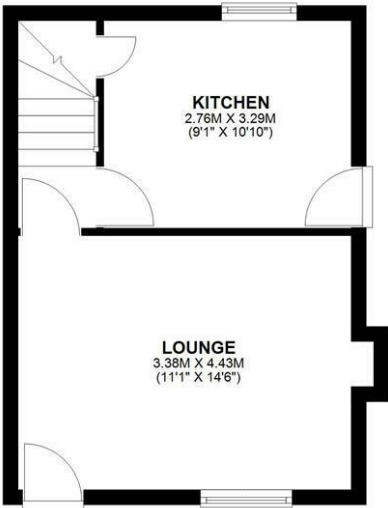

TOTAL AREA: APPROX. 64.4 SQ. METRES (693.0 SQ. FEET)

All measurements and details within this floorplan are approximate and are provided for illustrative purposes only. While every reasonable effort has been made to ensure accuracy, no responsibility is accepted for any errors, omissions, or misstatements. This floorplan should not be relied upon as a statement of fact and does not form part of any offer or contract. Prospective purchasers are advised to verify all measurements and details to their own satisfaction. Fixtures, fittings, services, systems, and appliances shown have not been tested and no warranty is given as to their operability or efficiency.
Plan produced using PlanUp.

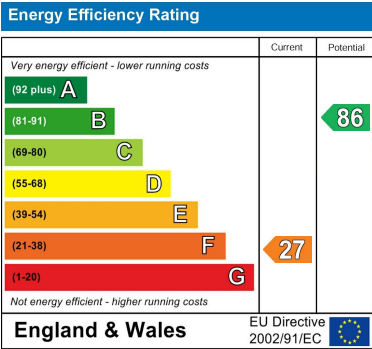

Unit 3 Mason Court Gillan Way, Penrith 40 Business Park
Penrith
Cumbria
CA11 9GR
01768881111
Sales@brittonestates.co.uk
www.brittonestates.co.uk