



Ulcat Row | Matterdale | Penrith | CA11 0LE

Guide Price £975,000



david britton
ESTATES

Key features

- Stunning Detached Cumbrian Longhouse
- Fully renovated to an immaculate standard
- Nestled at the foot of Gowbarrow Fell and enjoying views of Blencathra
- Standalone position, in around 0.5 acre plot
- Panoramic Views of the Lakeland Fells
- 3 reception rooms including a stunning oak framed garden room
- 3 double bedroom and 3 stylish bathrooms
- Landscaped and Established gardens, Ample driveway and parking
- No onward chain
- Lake District National Park Location, just minutes from Ullswater

Description

Presenting a rare opportunity to acquire a meticulously renovated Cumbrian long house, steeped in over 200 years of history and boasting breathtaking, unobstructed views of the Lakeland Fells. This exceptional property, situated within the Lake District National Park, occupies a coveted standalone position and has been recently transformed to an impeccable standard.

Directions





Floor plans

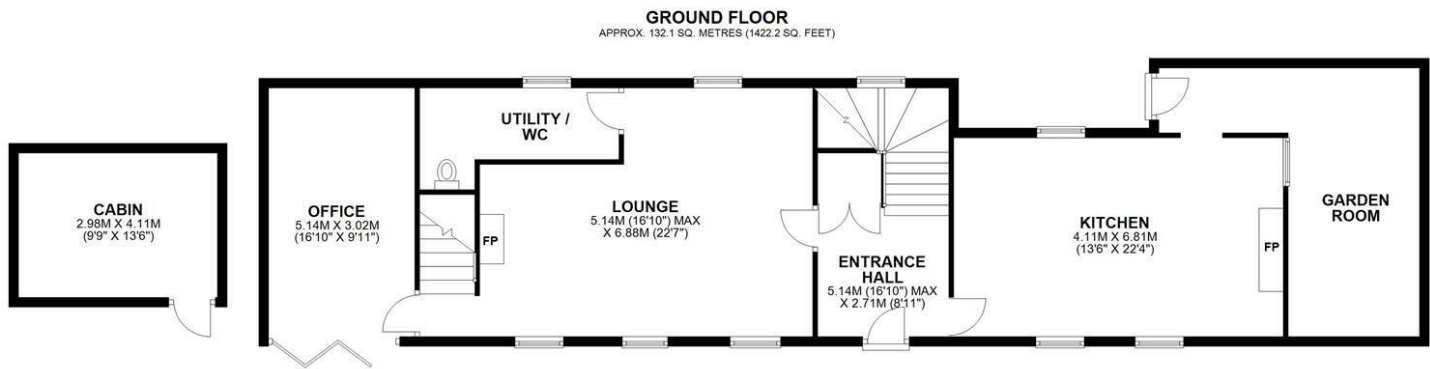

TOTAL AREA: APPROX. 234.0 SQ. METRES (2519.1 SQ. FEET)

All measurements and details within this floorplan are approximate and are provided for illustrative purposes only. While every reasonable effort has been made to ensure accuracy, no responsibility is accepted for any errors, omissions, or misstatements. This floorplan should not be relied upon as a statement of fact and does not form part of any offer or contract. Prospective purchasers are advised to verify all measurements and details to their own satisfaction. Fixtures, fittings, services, systems, and appliances shown have not been tested and no warranty is given as to their operability or efficiency.
Plan produced using PlanUp.

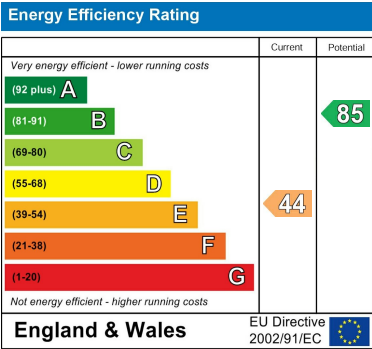

Unit 3 Mason Court Gillan Way, Penrith 40 Business Park
Penrith
Cumbria
CA11 9GR
01768881111
Sales@brittonestates.co.uk
www.brittonestates.co.uk