



| Great Salkeld | Penrith | CA11 9NA

£475,000



david britton
ESTATES

Key features

- Detached house
- Five bedrooms
- Three bathrooms
- Open plan living kitchen diner
- Balcony
- Gardens
- Garage with driveway parking
- Popular Village location

Description

Beautifully finished five bedroomed detached family home in the stunning Eden Valley Village of Great Salkeld. Right in the heart of the Village, with fell views from the front bedrooms, integral garage, a jaw dropping open plan living kitchen diner and tranquil rear garden, not to be missed!

Directions





Floor plans

GROUND FLOOR
30.5 sq.m. (328 sq.ft.) approx.



1ST FLOOR
79.1 sq.m. (852 sq.ft.) approx.



2ND FLOOR
45.3 sq.m. (487 sq.ft.) approx.

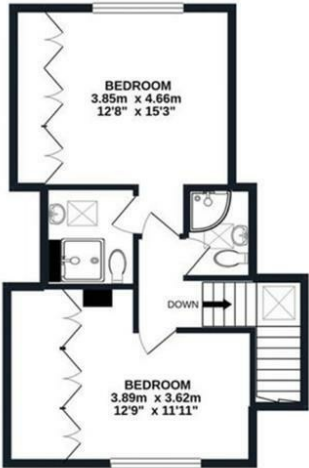

TOTAL FLOOR AREA : 154.9 sq.m. (1667 sq.ft.) approx.
Made with Metropix ©2021

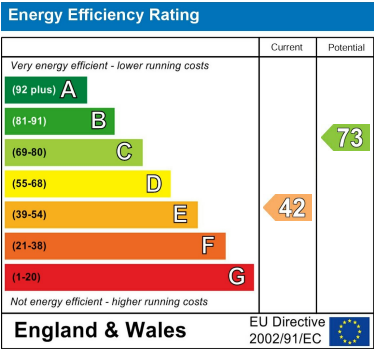

Unit 3 Mason Court Gillan Way, Penrith 40 Business Park
Penrith
Cumbria
CA11 9GR
01768881111
Sales@brittonestates.co.uk
www.brittonestates.co.uk