



Sowerby Lodge | Brough Sowerby | Kirkby Stephen | CA17 4EG

Guide Price £230,000



david britton
ESTATES

Key features

- 3 bedroom recently refurbished Cottage
- Reverse style living accommodation
- Large open plan living/dining/kitchen
- Three Ground floor bedrooms
- Stylish Family bathroom
- High quality fixtures and fittings
- Low maintenance courtyard garden
- Parking to the front
- Close to Kirkby Stephen and Appleby
- Excellent transport links

Description

Stunning three bedroomed end terraced cottage, recently renovated by well renowned local developers Stoneswood, just outside Brough Sowerby near Kirkby Stephen, enjoying reverse style living and courtyard garden.

Directions





Floor plans

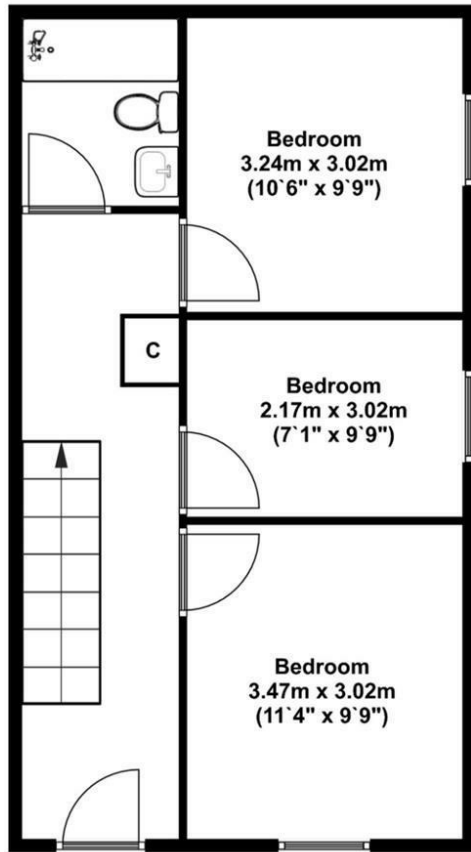

Ground Floor
Approx 45.00 Sq meters (484.00 Sq feet).

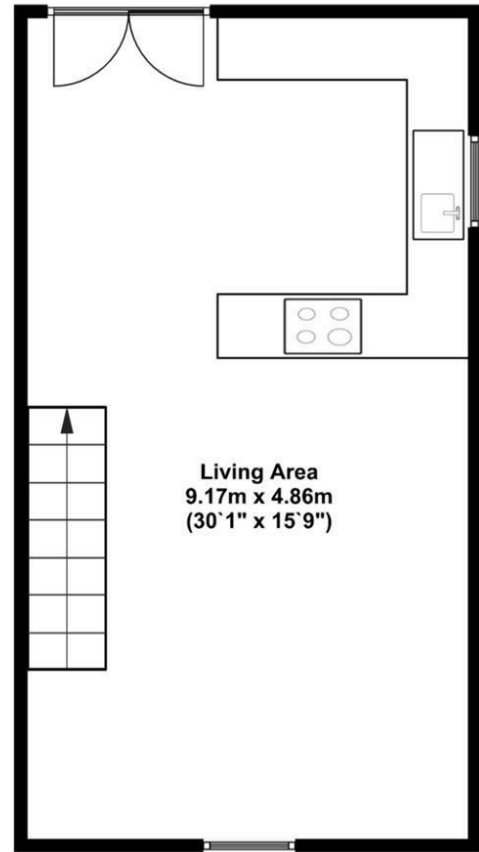

First Floor
Approx 45.00 Sq meters (484.00 Sq feet).



Energy Efficiency Rating		
	Current	Potential
<i>Very energy efficient - lower running costs</i>		
(92 plus) A		
(81-91) B		
(69-80) C		
(55-68) D		
(39-54) E		
(21-38) F		
(1-20) G		
<i>Not energy efficient - higher running costs</i>		
England & Wales	EU Directive 2002/91/EC	



Unit 3 Mason Court Gillan Way, Penrith 40 Business Park
 Penrith
 Cumbria
 CA11 9GR
 01768881111
 Sales@brittonestates.co.uk
 www.brittonestates.co.uk