



Living  
made  
better

Kestrel House  
Greenwich, SE10 8FP



£1,750 PCM

# Kestrel House, Greenwich, SE10 8FP

Madison Brook

## Property Summary

Situated on the sixth floor of Kestrel House, this bright and well-maintained one-bedroom apartment offers comfortable modern living with the benefit of a private balcony and concierge services. The property features a spacious reception room with room for dining and direct access to the balcony, a separate fitted kitchen, a generous double bedroom, and a contemporary three-piece bathroom.

Residents enjoy the convenience of a concierge service, while the location provides easy access to the station, town centre, and a wide range of local amenities.

## Floorplan

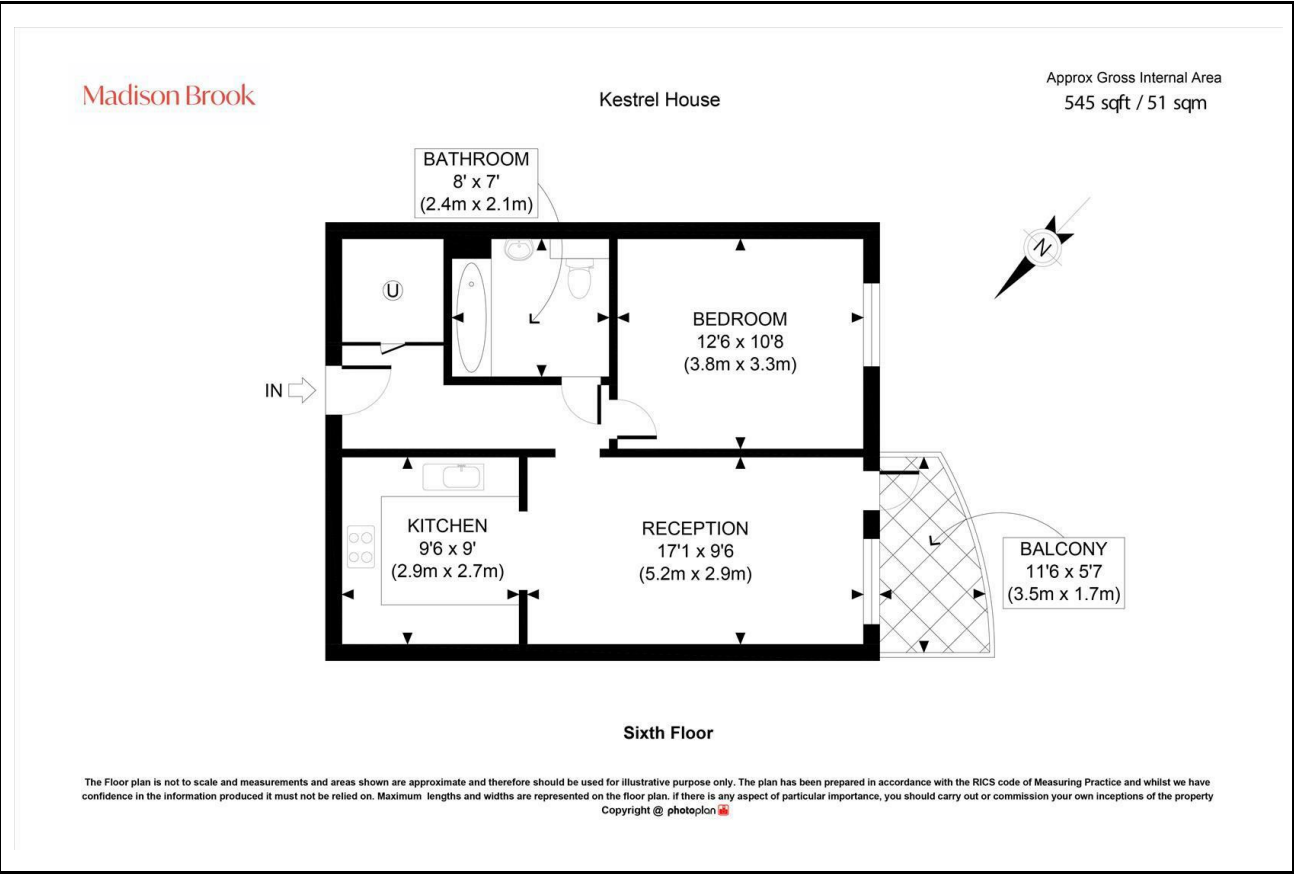

These particulars, whilst believed to be accurate are set out as a general outline only for guidance and do not constitute any part of an offer or contract. Intending purchasers should not rely on them as statements of representation of fact, but must satisfy themselves by inspection or otherwise as to their accuracy. No person in this firm's employment has the authority to make or give any representation or warranty in respect of the property.

## Area Map

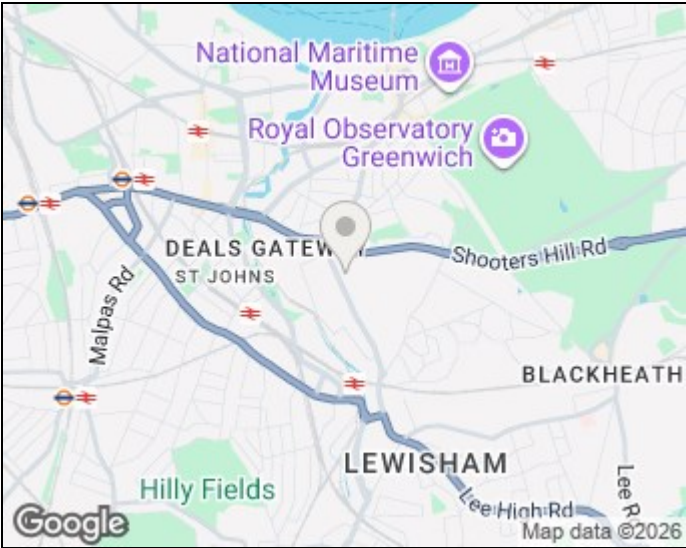

## Energy Efficiency Graph

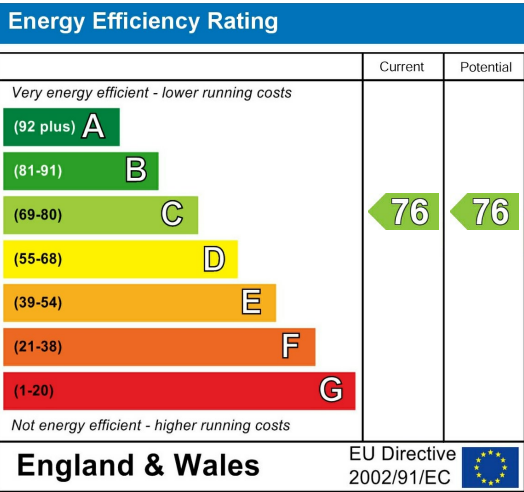

43 Loampit Vale, Lewisham, London, SE13 7FT  
Tel: 020 3946 6200 Email:  
lewisham@madisonbrook.com  
<https://madisonbrook.com/>