



Living
made
better

Cherrywood Lodge
Hither Green, SE13 6UR



Offers In Excess Of £250,000

Cherrywood Lodge, Hither Green, SE13 6UR

Madison Brook

Property Summary

A chain-free one-bedroom apartment on the second floor of Cherrywood Lodge, offering approx. 530 sq. ft. The property features an open-plan reception/kitchen/dining room with a Juliet balcony, a generous double bedroom with built-in storage, and a modern fully tiled bathroom. Benefits include an allocated parking space and a convenient location close to amenities, Hither Green Station (approx. 0.5 miles) and Mountsfield Park (approx. 0.2 miles).

Service charge: £2,400 pa | Ground rent: £225 pa | Lease: 101 years remaining

Floorplan

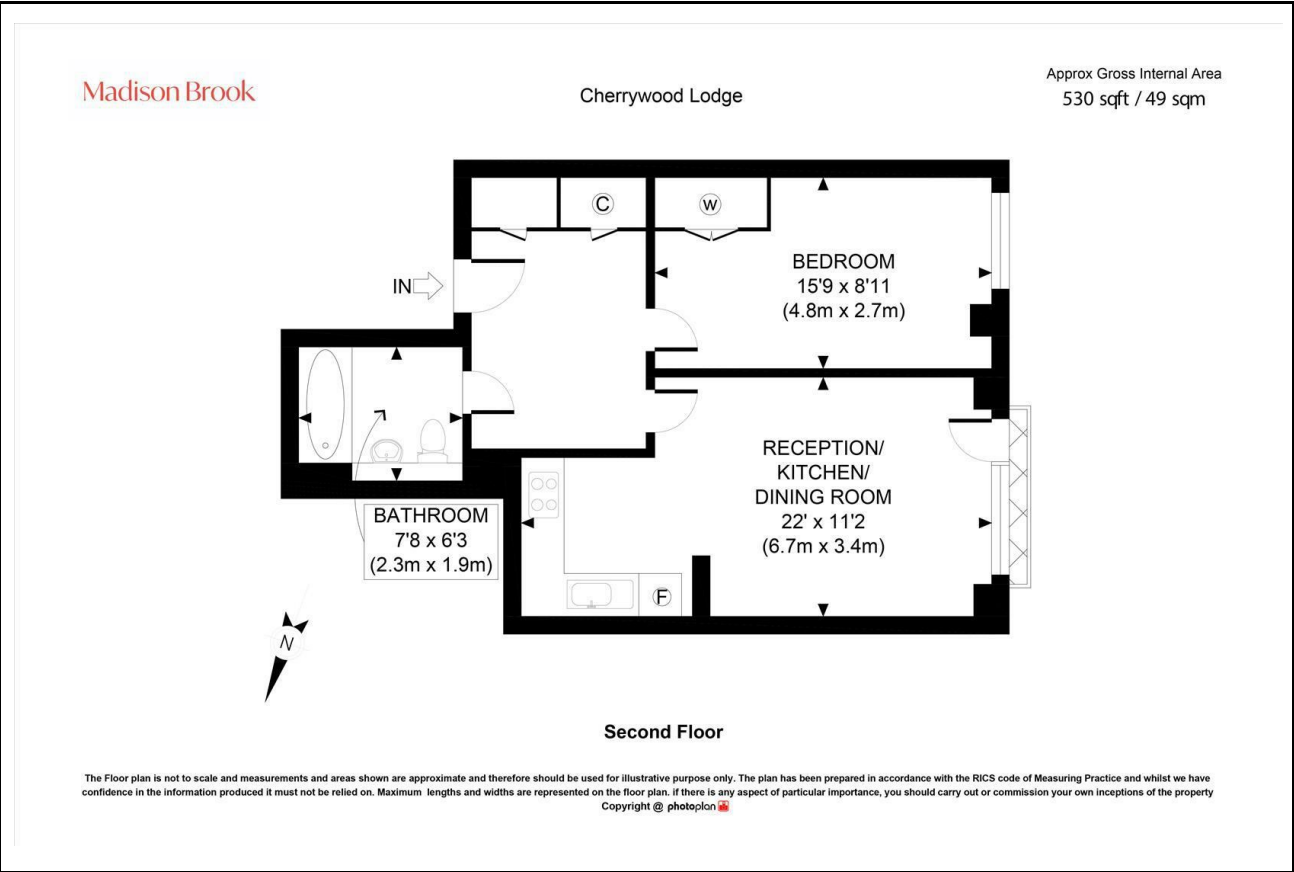

Area Map

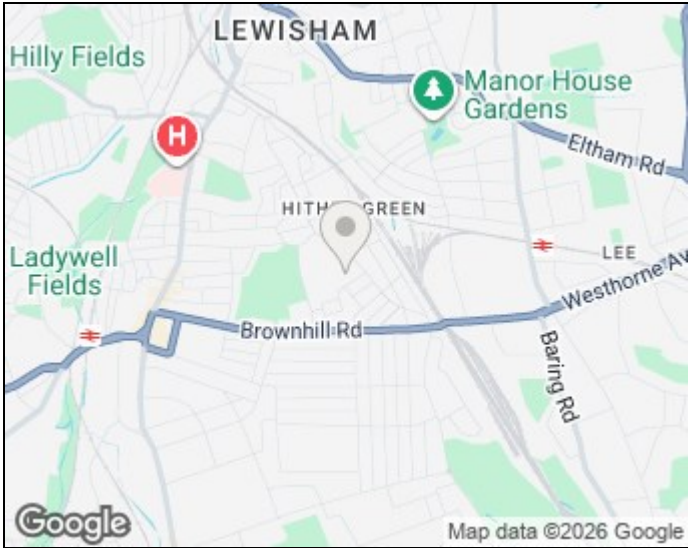

Energy Efficiency Graph

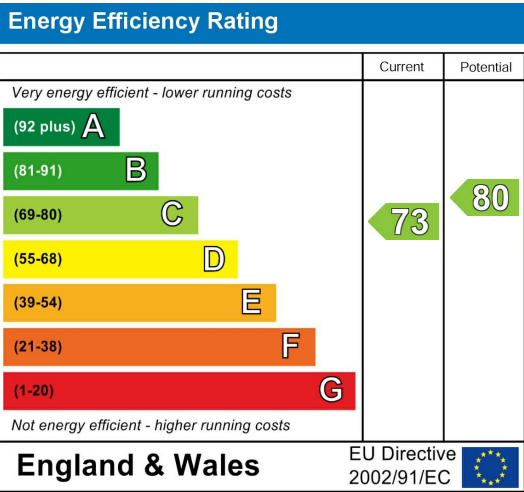

These particulars, whilst believed to be accurate are set out as a general outline only for guidance and do not constitute any part of an offer or contract. Intending purchasers should not rely on them as statements of representation of fact, but must satisfy themselves by inspection or otherwise as to their accuracy. No person in this firm's employment has the authority to make or give any representation or warranty in respect of the property.

43 Loampit Vale, Lewisham, London, SE13 7FT
Tel: 020 3946 6200 Email:
lewisham@madisonbrook.com
<https://madisonbrook.com/>