

Living
made
better

City Peninsula
North Greenwich, SE10 0FN

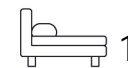

Offers In Excess Of £325,000

City Peninsula, North Greenwich, SE10 0FN

Madison Brook

Property Summary

Set on the eighth floor of the sought-after City Peninsula development, this bright and modern one-bedroom apartment offers stylish living with a private balcony and partial views towards the O2 Arena. The open-plan kitchen/living area features high-gloss units, integrated appliances, and granite worktops, while the double bedroom includes a built-in wardrobe. A three-piece bathroom completes the layout. Residents benefit from a concierge service and superb transport links, with North Greenwich Station (Jubilee Line) just 0.6 miles away. The O2 Arena, cable car, and riverside amenities are all within walking distance. Offered chain free.

Service charge: £3,380 pa | Ground rent: £200 pa | Lease: 229 years remaining

Floorplan

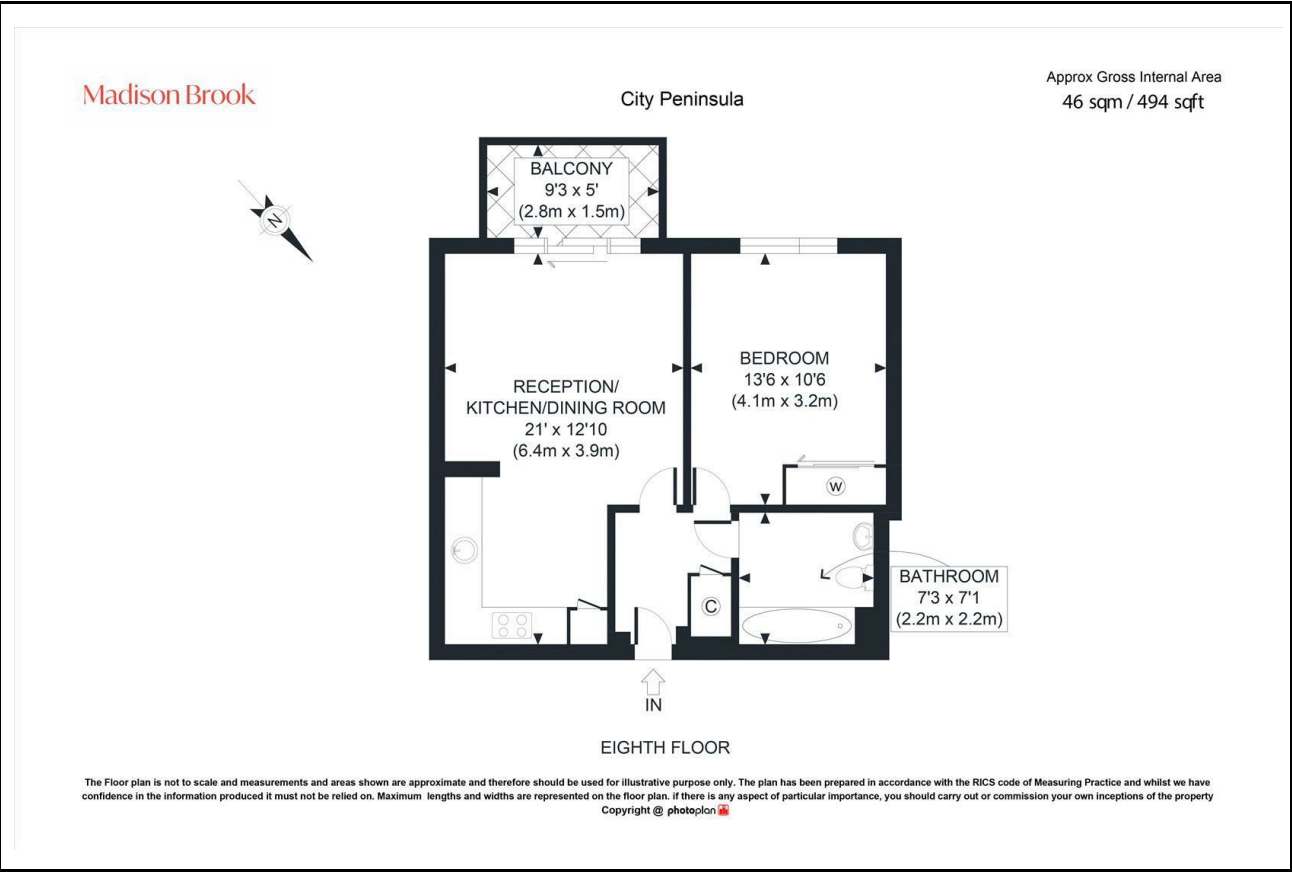

Area Map



Energy Efficiency Graph

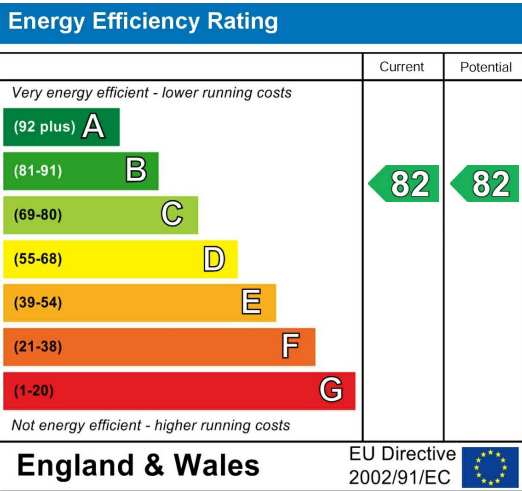

43 Loampit Vale, Lewisham, London, SE13 7FT
Tel: 020 3946 6200 Email: lewisham@madisonbrook.com
<https://madisonbrook.com/>

These particulars, whilst believed to be accurate are set out as a general outline only for guidance and do not constitute any part of an offer or contract. Intending purchasers should not rely on them as statements of representation of fact, but must satisfy themselves by inspection or otherwise as to their accuracy. No person in this firms employment has the authority to make or give any representation or warranty in respect of the property.