

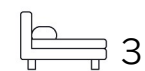

Living
made
better

Lansdowne Mews
Charlton, SE7 8AZ



£2,000 PCM

Lansdowne Mews, Charlton, SE7 8AZ

Madison Brook

Property Summary

A three-bedroom house in Charlton (SE7), offering 936 sq. ft. of living space with front and rear gardens. The ground floor features a bright living room opening onto a generous garden, a kitchen/dining room, and a separate WC. Upstairs are three bedrooms and a family bathroom. Benefits include driveway parking, great transport links, and easy access to London Bridge, Canary Wharf, and the City.

Floorplan

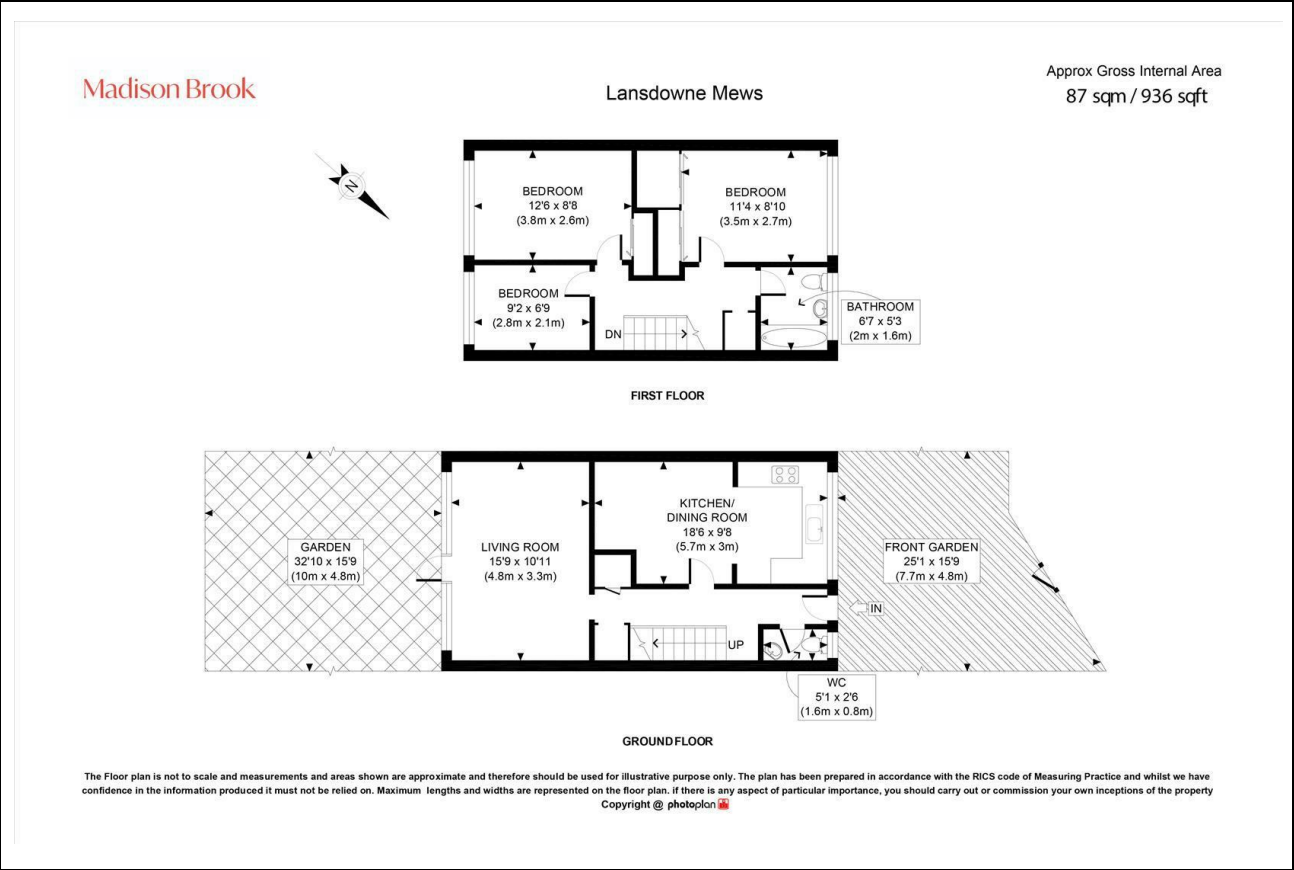

Area Map

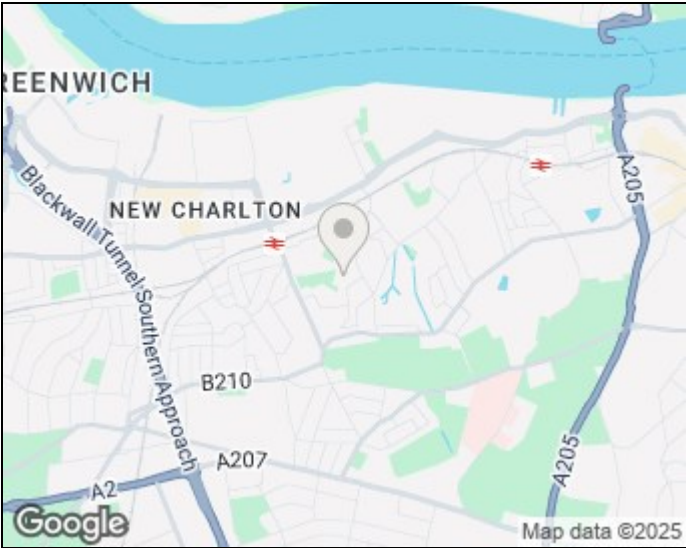

Energy Efficiency Graph

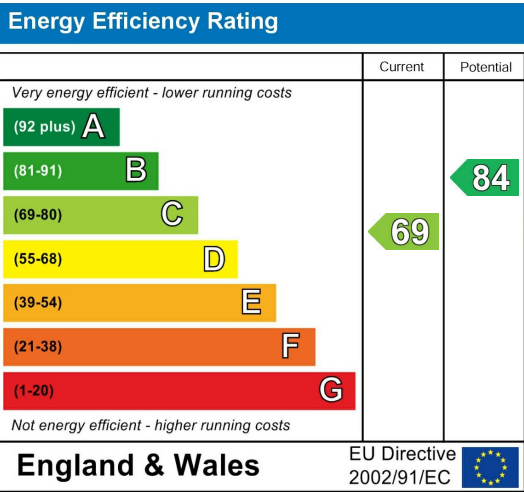

These particulars, whilst believed to be accurate are set out as a general outline only for guidance and do not constitute any part of an offer or contract. Intending purchasers should not rely on them as statements of representation of fact, but must satisfy themselves by inspection or otherwise as to their accuracy. No person in this firms employment has the authority to make or give any representation or warranty in respect of the property.

43 Loampit Vale, Lewisham, London, SE13 7FT
Tel: 020 3946 6200 Email:
lewisham@madisonbrook.com
<https://madisonbrook.com/>