

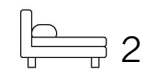

Living  
made  
better

Building 22 Cadogan Road  
Woolwich, SE18 6YR



£2,100 PCM

# Building 22 Cadogan Road, Woolwich, SE18

6YR

## Property Summary

This beautifully presented two-bedroom duplex is set over the third and fourth floors of the iconic Building 22—formerly the Royal Arsenal’s headquarters. Overlooking Wellington Park, the apartment features generous ceiling heights, a bright open-plan living space with modern kitchen, and a private south-facing balcony.

Exceptional transport links: the Elizabeth Line is on-site (under 2 minutes), with DLR, National Rail, and Thames Clipper services all within a 5-minute walk.

## Floorplan

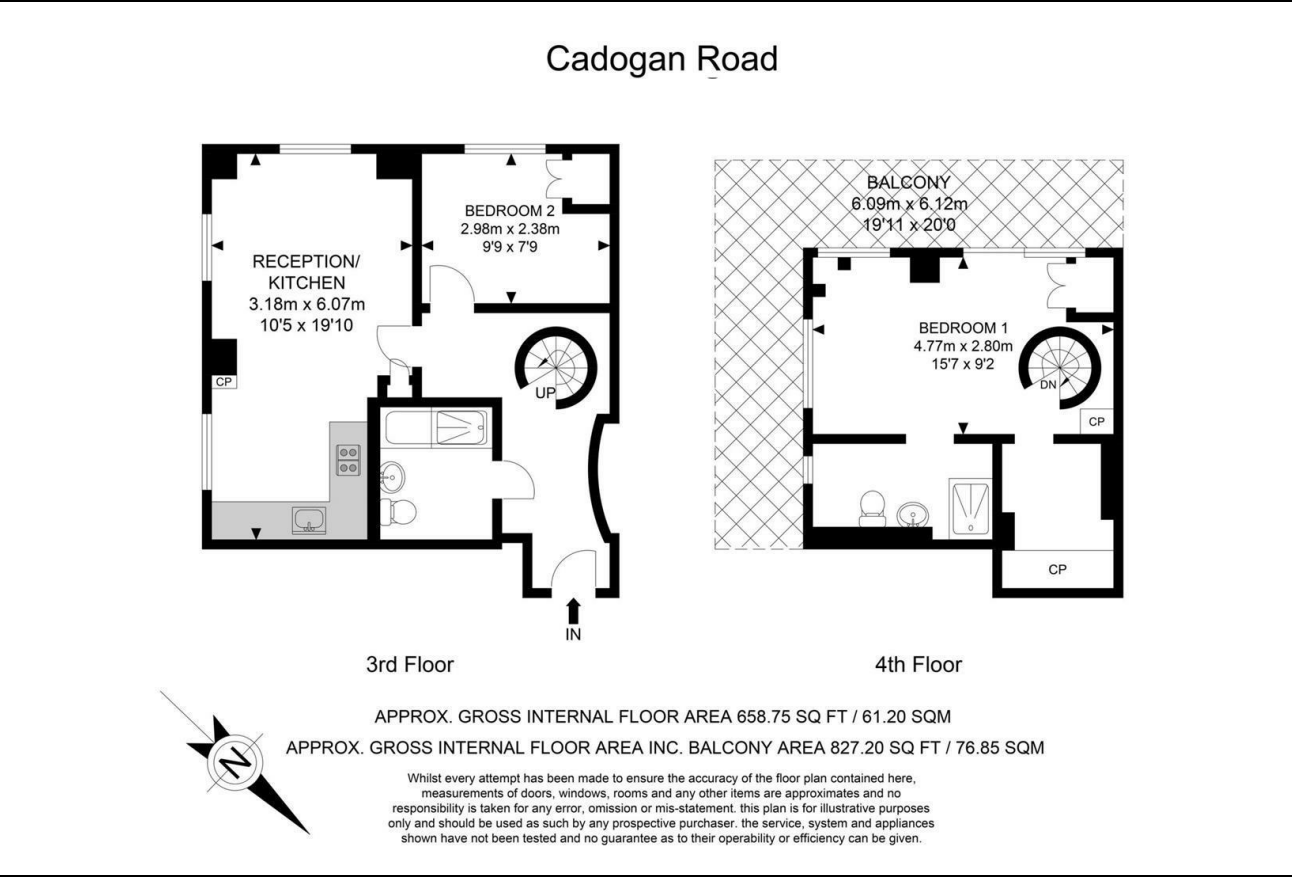

These particulars, whilst believed to be accurate are set out as a general outline only for guidance and do not constitute any part of an offer or contract. Intending purchasers should not rely on them as statements of representation of fact, but must satisfy themselves by inspection or otherwise as to their accuracy. No person in this firm's employment has the authority to make or give any representation or warranty in respect of the property.

Madison Brook

## Area Map

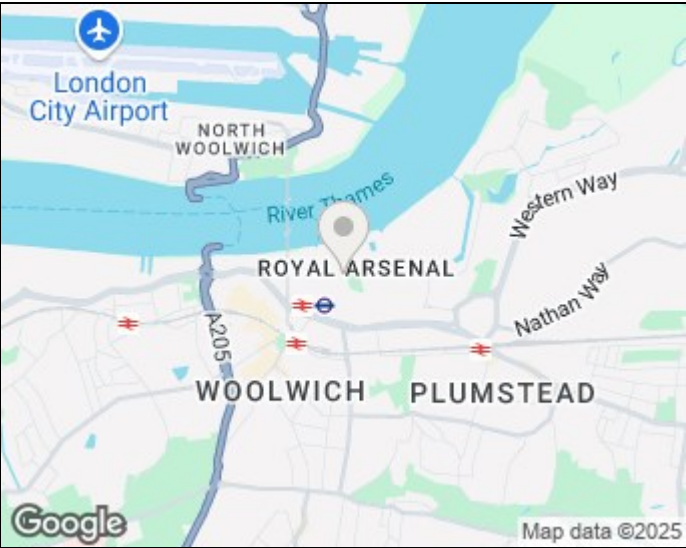

## Energy Efficiency Graph

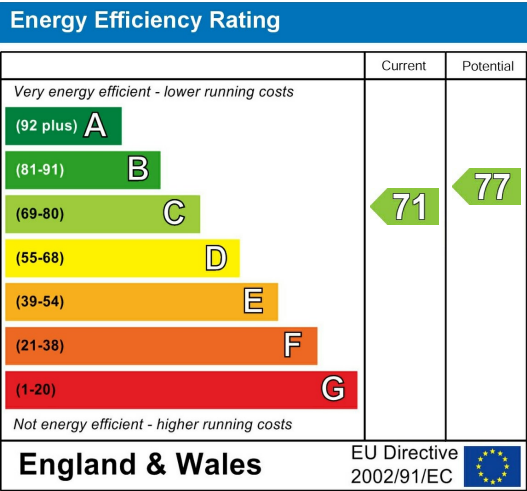

43 Loampit Vale, Lewisham, London, SE13 7FT  
Tel: 020 3946 6200 Email: lewisham@madisonbrook.com  
<https://madisonbrook.com/>