



Living  
made  
better

Amphion House  
Woolwich, SE18 6NW



Offers In Excess Of £575,000

# Amphion House, Woolwich, SE18 6NW

Madison Brook

### Property Summary

Set within a highly sought-after riverside development, this stunning two-bedroom apartment combines modern living with exclusive resident amenities.

Residents enjoy 24-hour concierge service, a state-of-the-art gym, cinema room, and swimming pool, offering a premium lifestyle. Perfectly located for fast connections to Canary Wharf and central London, this home is a fantastic opportunity for professionals, investors, or first-time buyers.

### Floorplan

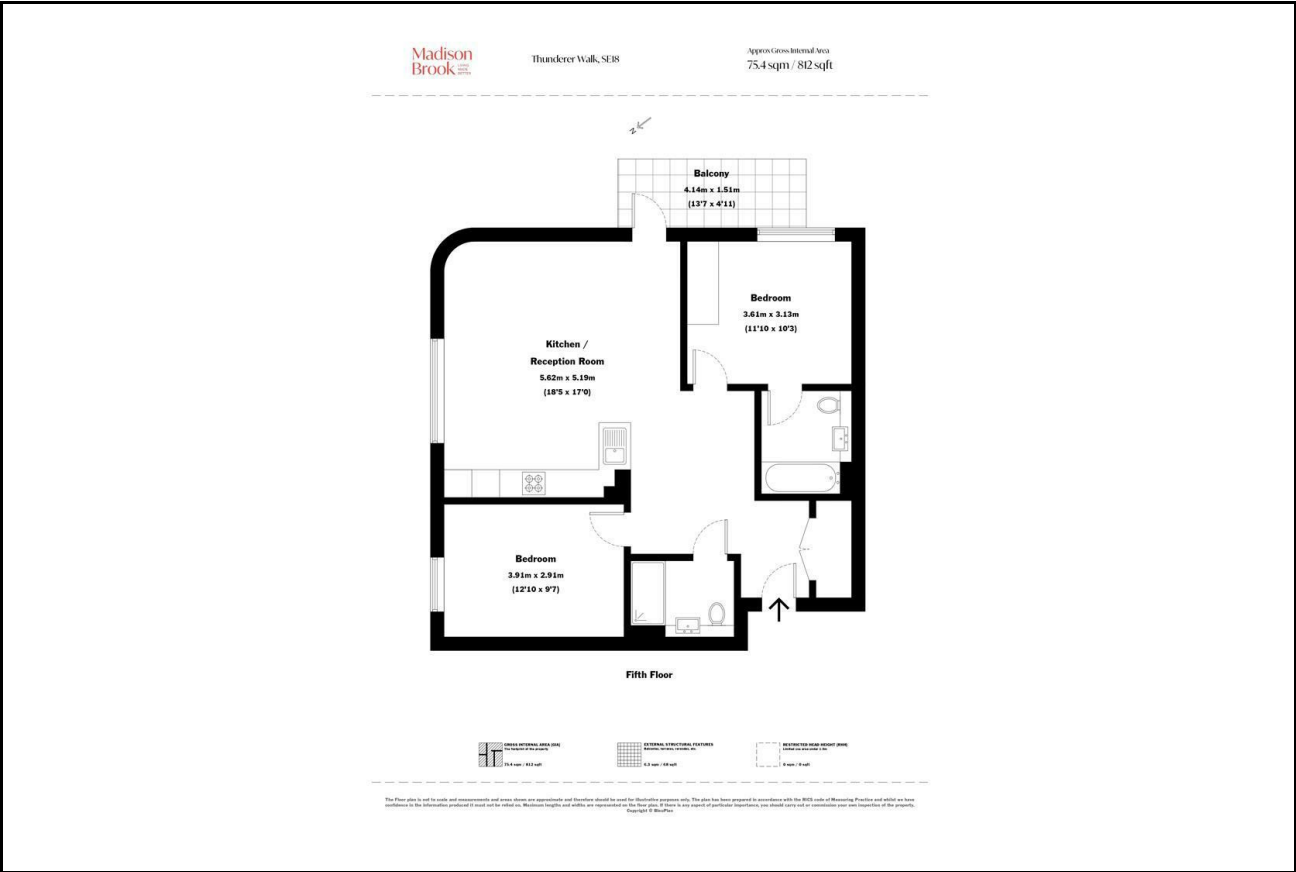

These particulars, whilst believed to be accurate are set out as a general outline only for guidance and do not constitute any part of an offer or contract. Intending purchasers should not rely on them as statements of representation of fact, but must satisfy themselves by inspection or otherwise as to their accuracy. No person in this firm's employment has the authority to make or give any representation or warranty in respect of the property.

### Area Map

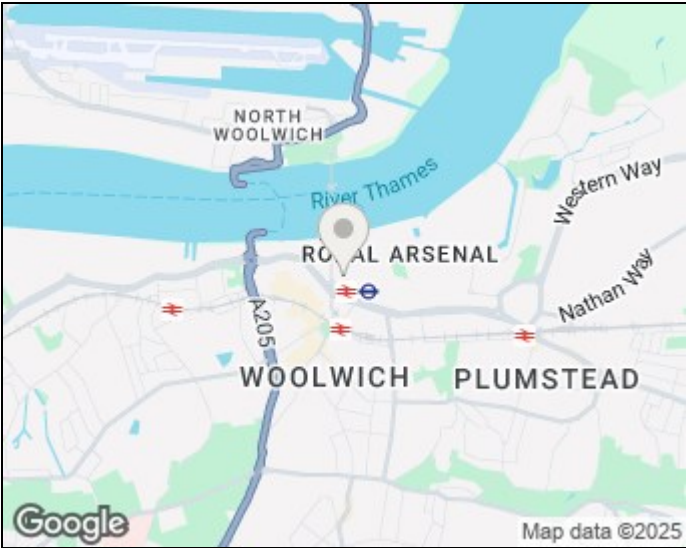

### Energy Efficiency Graph

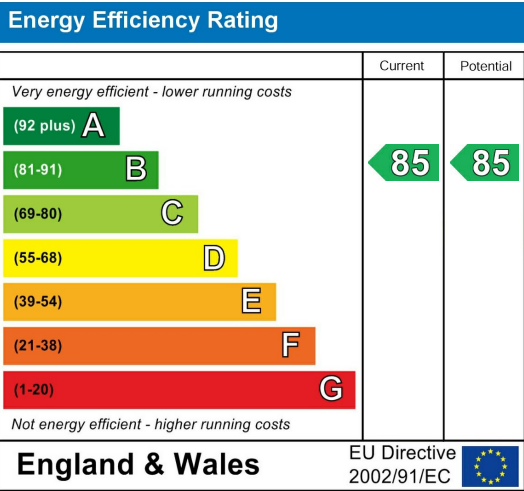

43 Loampit Vale, Lewisham, London, SE13 7FT  
Tel: 020 3946 6200 Email: [lewisham@madisonbrook.com](mailto:lewisham@madisonbrook.com)  
<https://madisonbrook.com/>