

Living
made
better

Building 47
Woolwich, SE18 6RU



Offers In Excess Of £550,000

Building 47, Woolwich, SE18 6RU

Madison Brook

Property Summary

A two/three bed conversion with an array of features, bags of character and a "real" view of the river! Benefitting from several significant enhancements to the original specification, this beautifully presented, split-level warehouse truly is a cut above the rest. Three bedrooms (two enclosed, one galleried above reception) a mass of exposed brickwork, original columns, double height to dual aspect reception with enormous windows, providing a wonderful sweeping view across the river. Allocated parking, 24hr concierge and residents gym provide the icing on the cake.

Floorplan

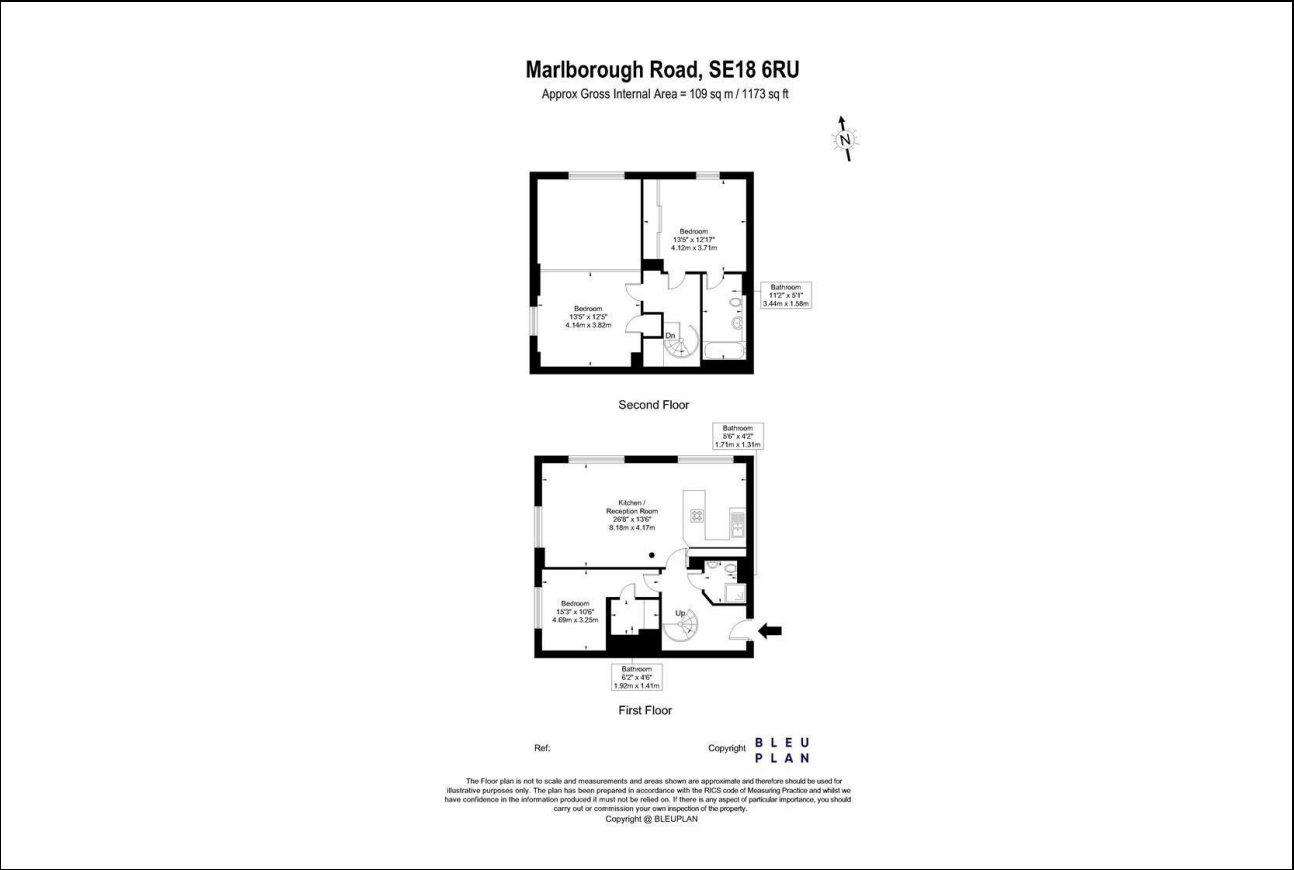

Area Map

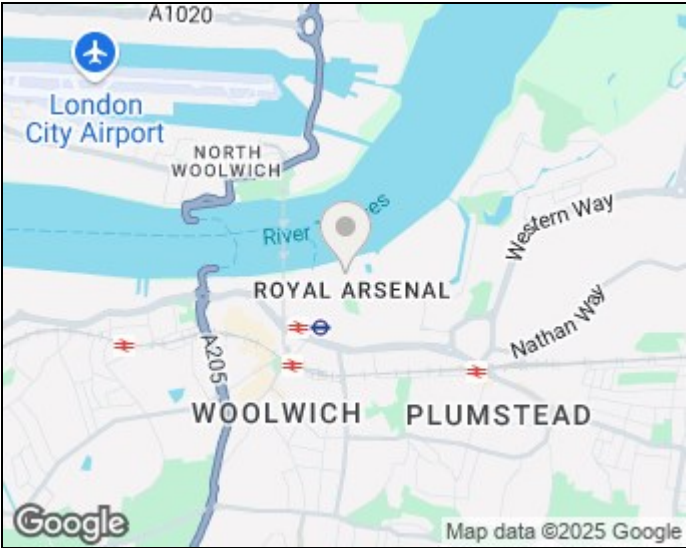

Energy Efficiency Graph

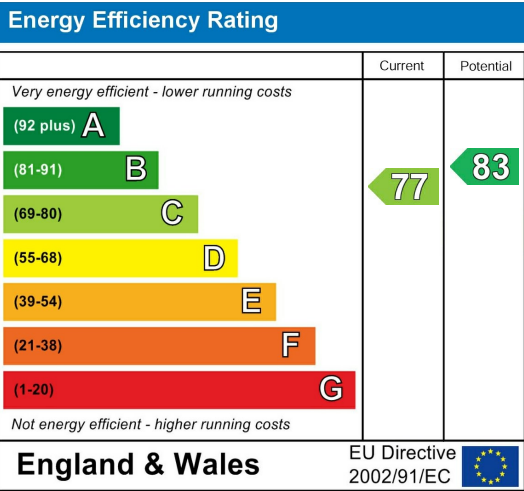

These particulars, whilst believed to be accurate are set out as a general outline only for guidance and do not constitute any part of an offer or contract. Intending purchasers should not rely on them as statements of representation of fact, but must satisfy themselves by inspection or otherwise as to their accuracy. No person in this firms employment has the authority to make or give any representation or warranty in respect of the property.

43 Loampit Vale, Lewisham, London, SE13 7FT
Tel: 020 3946 6200 Email: lewisham@madisonbrook.com
<https://madisonbrook.com/>