

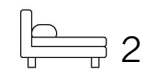

Living  
made  
better

Venice Corte  
Lewisham, SE13 7FW



Offers In Excess Of £375,000



# Venice Corte, Lewisham, SE13 7FW

Madison Brook

## Property Summary

This modern two-bedroom first-floor apartment in SE13 offers the perfect blend of style and convenience. The bright and spacious reception room opens onto a private balcony, ideal for enjoying your morning coffee or relaxing after a busy day. The sleek kitchen is equipped with high-spec appliances and ample storage, perfectly catering to contemporary living. Both bedrooms are generously sized, with the principal featuring built-in wardrobes for added practicality. The bathroom boasts a modern three-piece suite with a polished finish. Located close to Lewisham DLR and train station, commuting to Canary Wharf or central London is effortless.

## Floorplan

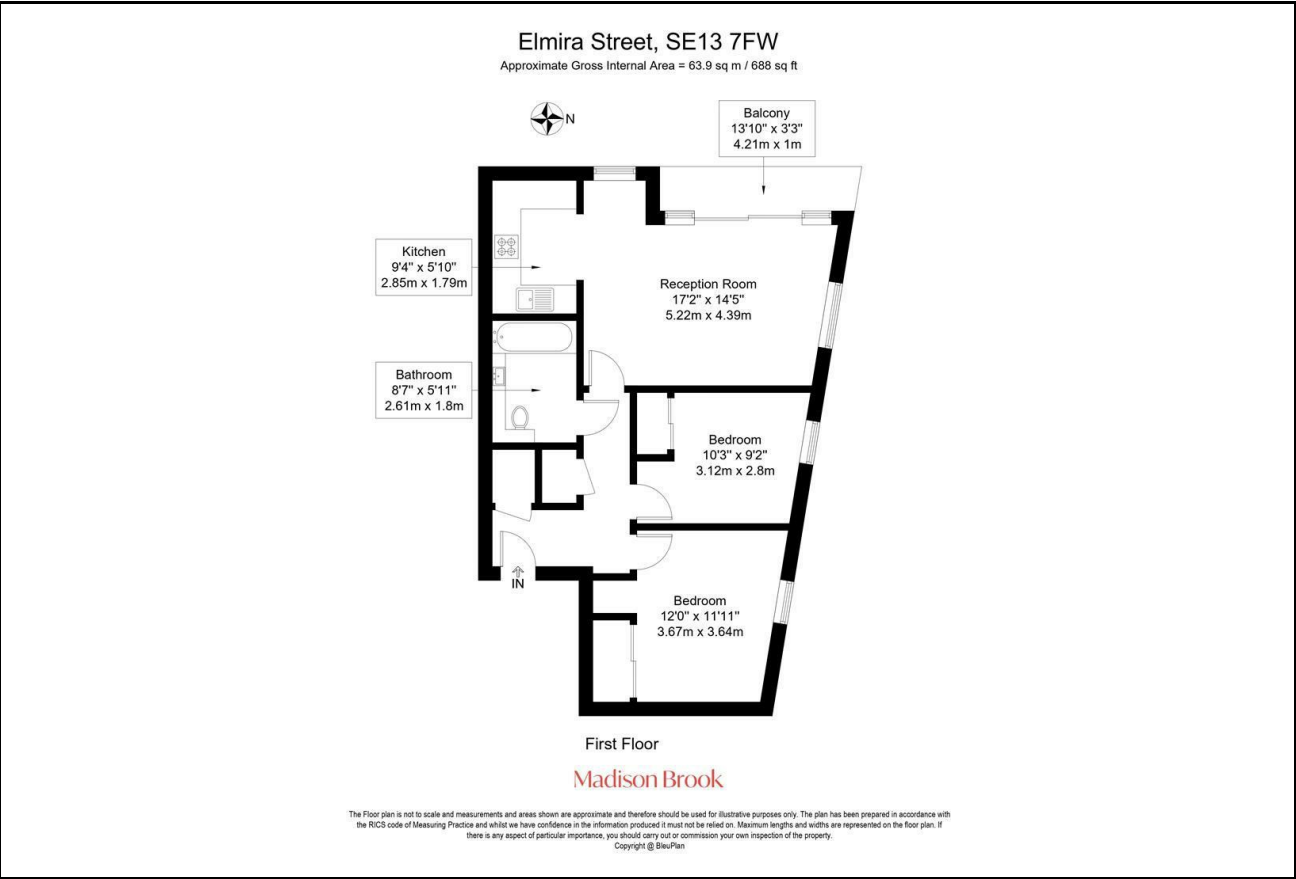

## Area Map

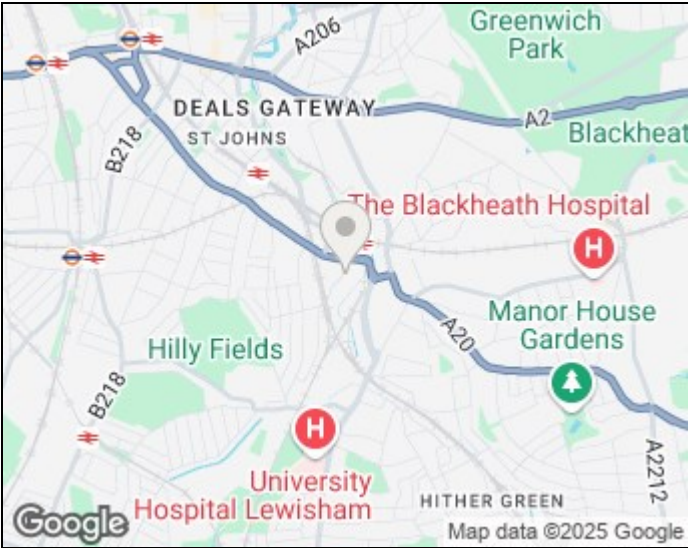

## Energy Efficiency Graph

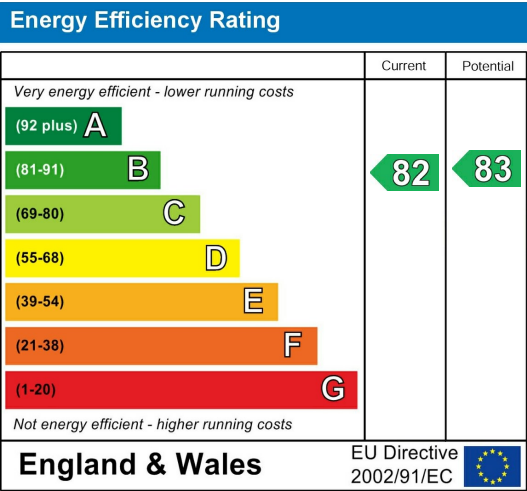

These particulars, whilst believed to be accurate are set out as a general outline only for guidance and do not constitute any part of an offer or contract. Intending purchasers should not rely on them as statements of representation of fact, but must satisfy themselves by inspection or otherwise as to their accuracy. No person in this firms employment has the authority to make or give any representation or warranty in respect of the property.

43 Loampit Vale, Lewisham, London, SE13 7FT  
Tel: 020 3946 6200 Email: [lewisham@madisonbrook.com](mailto:lewisham@madisonbrook.com)  
<https://madisonbrook.com/>