

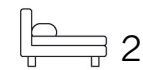

Living
made
better

Station Road
London, SE13 5FS



£2,300 Per Month

Station Road, London SE13 5FS

Madison Brook

New to the market, stunning two-bedroom, two-bathroom house located on Station Road. Situated in the popular River Mill One development in Lewisham, this modern apartment offers breath-taking views over London from the twentieth floor.

Within this beautifully presented property, you are greeted by a spacious reception room perfect for entertaining guests or relaxing after a long day. The two bedrooms provide ample space for a small family or professionals looking for a comfortable living space. With two bathrooms, convenience is key in this contemporary home.

Built in 2017, this property boasts a modern design and is well-maintained, offering a fresh and inviting atmosphere. The 786 sq ft of living space provides plenty of room to make this house your own.

The location of this apartment is truly unbeatable, being close to Lewisham station and the DLR, making commuting a breeze.



Floorplan

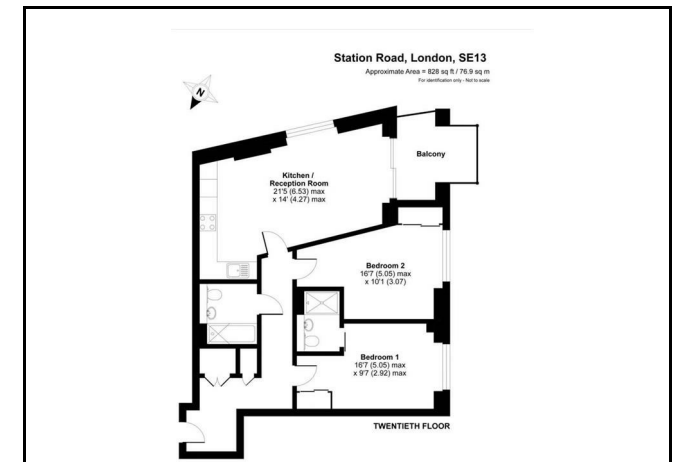

Area Map

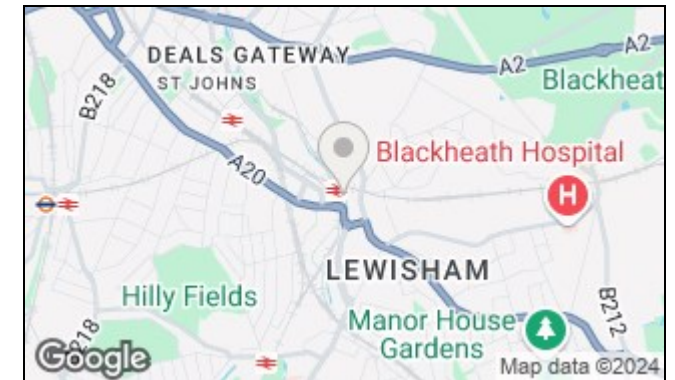

Energy Efficiency Graph

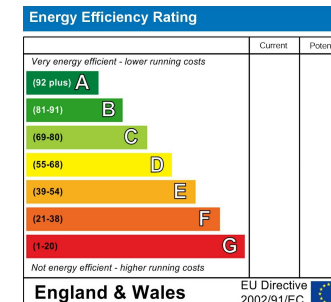

These particulars, whilst believed to be accurate are set out as a general outline only for guidance and do not constitute any part of an offer or contract. Intending purchasers should not rely on them as statements of representation of fact, but must satisfy themselves by inspection or otherwise as to their accuracy. No person in this firm's employment has the authority to make or give any representation or warranty in respect of the property.

43 Loampit Vale, Lewisham, London, SE13 7FT

Tel: 020 3946 6200 Email: lewisham@madisonbrook.com <https://madisonbrook.com/>