

Living  
made  
better

River Mill One  
Lewisham, SE13

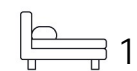

Offers In Excess Of £300,000

# River Mill One, Lewisham, SE13

Madison Brook

This stunning one bedroom apartment is located on the third floor of River Mill One, forming part of the Portrait Development which is located only 0.1 miles away from Lewisham Station.

Set within this modern building, you will benefit from a marvellous open plan reception room, with a stylish fully integrated kitchen, access to a private balcony with enough space for a table and chairs, a good sized double bedroom with built in storage & a beautifully finished bathroom all in great condition.

River Mill One benefits from an amazing location being only a 0.1 miles away from Lewisham Station giving access to the DLR (Docklands Light Railway) & Lewisham Overground, additionally you are 0.2 miles away from Lewisham town centre offering a large shopping centre, restaurants cafes and the popular Lewisham Market.

If you are looking for a Property For Sale in Lewisham and require further details, please do not hesitate to contact Madison Brook.



## Floorplan

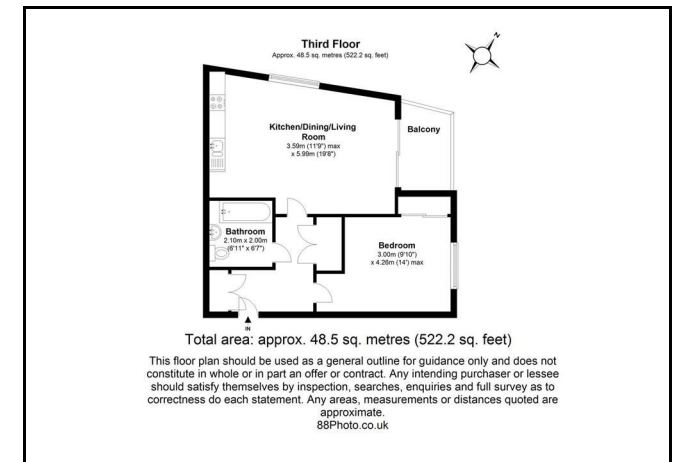

## Area Map

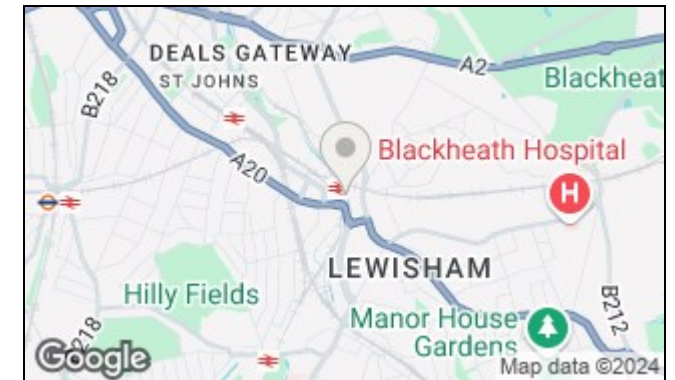

## Energy Efficiency Graph

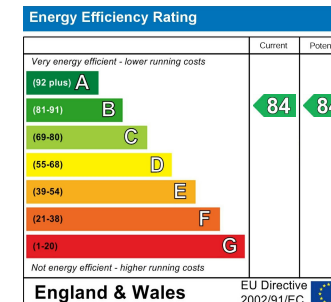

These particulars, whilst believed to be accurate are set out as a general outline only for guidance and do not constitute any part of an offer or contract. Intending purchasers should not rely on them as statements of representation of fact, but must satisfy themselves by inspection or otherwise as to their accuracy. No person in this firm's employment has the authority to make or give any representation or warranty in respect of the property.

43 Loampit Vale, Lewisham, London, SE13 7FT

Tel: 020 3946 6200 Email: [lewisham@madisonbrook.com](mailto:lewisham@madisonbrook.com) <https://madisonbrook.com/>