

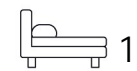

Living
made
better

River Mill One
Lewisham, SE13



Offers In Excess Of £300,000

River Mill One, Lewisham, SE13

This stunning one bedroom apartment is located on the third floor of River Mill One, forming part of the Portrait Development which is located only 0.1 miles away from Lewisham Station.

Set within this modern building, you will benefit from a marvellous open plan reception room, with a stylish fully integrated kitchen, access to a private balcony with enough space for a table and chairs, a good sized double bedroom with built in storage & a beautifully finished bathroom all in great condition.

River Mill One benefits from an amazing location being only a 0.1 miles away from Lewisham Station giving access to the DLR (Docklands Light Railway) & Lewisham Overground, additionally you are 0.2 miles away from Lewisham town centre offering a large shopping centre, restaurants cafes and the popular Lewisham Market.

If you are looking for a Property For Sale in Lewisham and require further details, please do not hesitate to contact Madison Brook.



Madison Brook

Floorplan

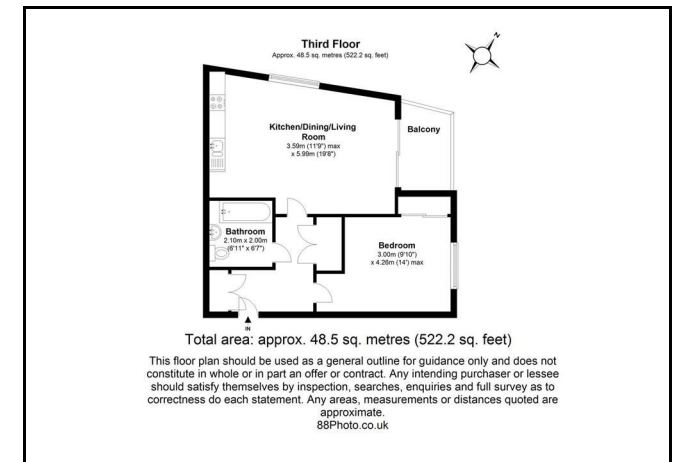

Area Map

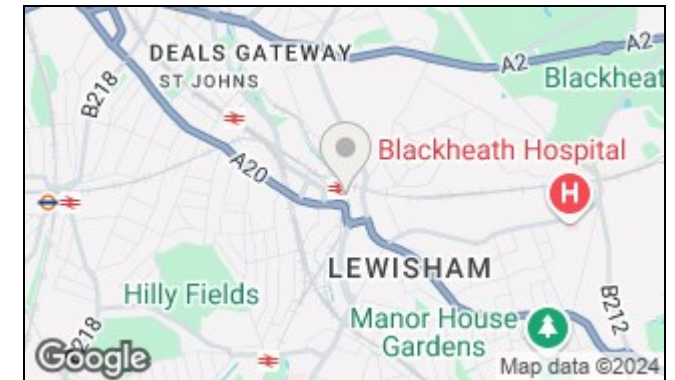

Energy Efficiency Graph

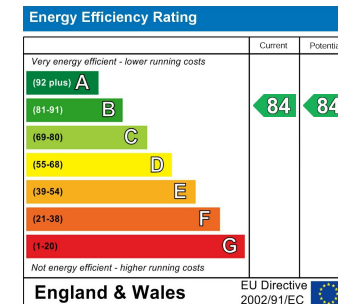

43 Loampit Vale, Lewisham, London, SE13 7FT

Tel: 020 3946 6200 Email: lewisham@madisonbrook.com <https://madisonbrook.com/>