



2 Cornmill Lane
, London, SE13 7FZ
£2,500 PCM



MADISON BROOK
INTERNATIONAL

2 Cornmill Lane, London, SE13 7FZ

This stunning, rarely available, two bedroom duplex penthouse apartment is located within Sienna Alto, forming part of the popular Renaissance development.

Set over two floors, offering 932 Sq. Ft of internal space, the first floor comprises of a bright, spacious living area providing picturesque views and a sleek open plan kitchen equipped with a range of integrated appliances; a principal bedroom with fitted double wardrobes and access to a stylish En-suite bathroom, a further well proportioned double bedroom and a family bathroom suite to the hallway. The second floor consists of spacious study with plenty of natural light and access to the private garden terrace, offering views of London's iconic landmarks.

Sienna Alto benefits from a 24-hour concierge and is located only a short walk from Lewisham Station offering the DLR and National Rail lines into Canary Wharf and the City.



These particulars, whilst believed to be accurate are set out as a general outline only for guidance and do not constitute any part of an offer or contract. Intending purchasers should not rely on them as statements of representation of fact, but must satisfy themselves by inspection or otherwise as to their accuracy. No person in this firm's employment has the authority to make or give any representation or warranty in respect of the property.

43 Loampit Vale, Lewisham, London, SE13 7FT

Tel: 020 3946 6200 Email: lewisham@madisonbrook.com <https://madisonbrook.com/>

Floor Plan

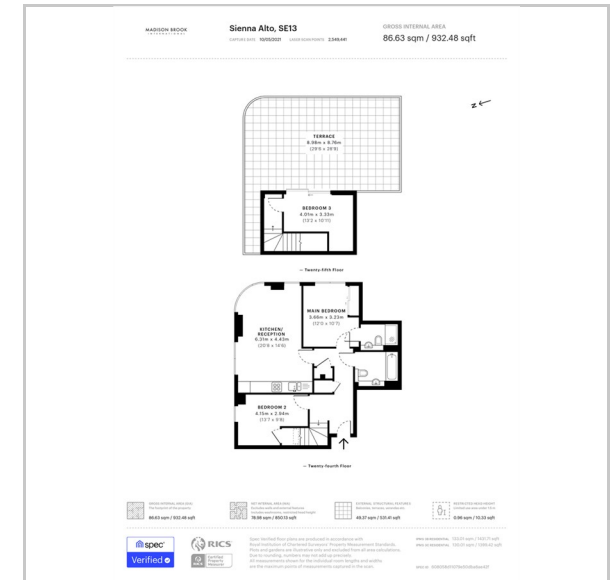

Area Map

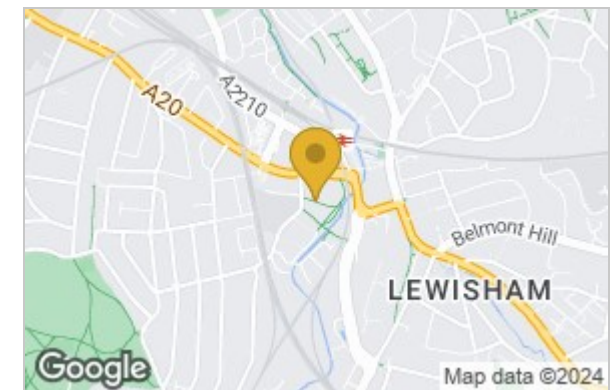

Energy Efficiency Graph

