

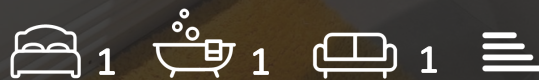

Calderwood Street  
, London, SE18 6JH  
£1,500 Per Month



**MADISON BROOK**  
INTERNATIONAL

# Calderwood Street, London, SE18 6JH

New to the market this charming apartment situated in Woolwich. The property boasts a good sized open plan reception room, a cosy bedroom, and a well-appointed bathroom, perfect for a comfortable living experience.

With 418 sq ft of living space, this apartment offers a blend of traditional charm and modern convenience. The property is thoughtfully designed, ensuring a well-presented interior that is both inviting and functional.

Situated in a prime location, you'll find yourself close to excellent transport links, including the DLR and the Elizabeth Line, making commuting a breeze. Additionally, the allocated parking space provides convenience for those with vehicles.

The property is surrounded by a plethora of social amenities, ensuring that you have everything you need right at your doorstep. Whether you're looking for trendy cafes, convenient shops, or relaxing green spaces, this location has it all.



These particulars, whilst believed to be accurate are set out as a general outline only for guidance and do not constitute any part of an offer or contract. Intending purchasers should not rely on them as statements of representation of fact, but must satisfy themselves by inspection or otherwise as to their accuracy. No person in this firm's employment has the authority to make or give any representation or warranty in respect of the property.

43 Loampit Vale, Lewisham, London, SE13 7FT

Tel: 020 3946 6200 Email: [lewisham@madisonbrook.com](mailto:lewisham@madisonbrook.com) <https://madisonbrook.com/>

## Floor Plan

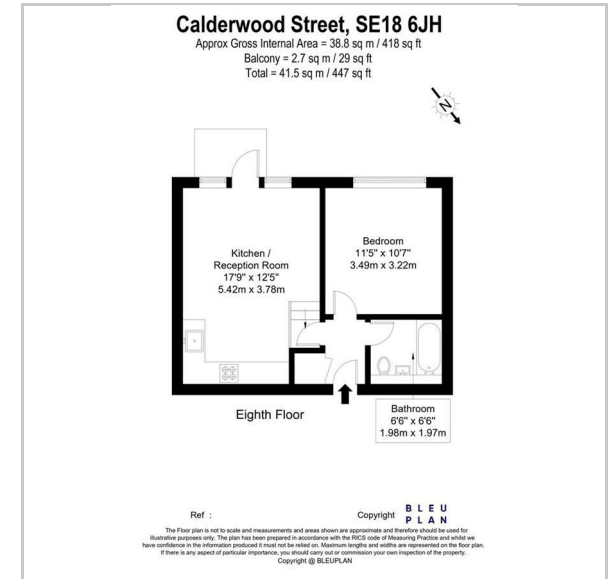

## Area Map

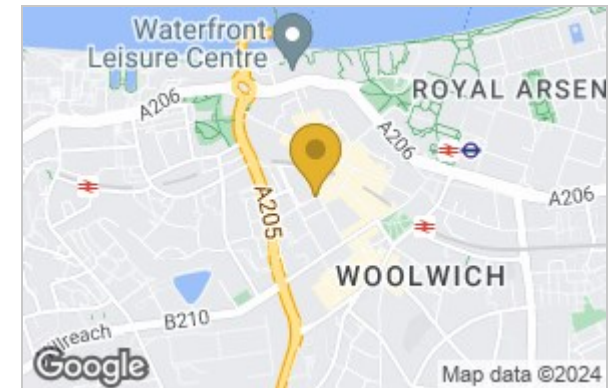

## Energy Efficiency Graph

