



Cornmill Lane
, London, SE13 7GH
£2,100 PCM



MADISON BROOK
INTERNATIONAL

Cornmill Lane, London, SE13 7GH

A two bedroom property, two bathroom flat on the tenth floor offering plenty of light from the tranquillity of the sizable private balcony.

This two bedroom apartment is located within the principle tower in one of Lewisham's most popular developments. Features include a modern fitted kitchen with integrated appliances, master bedroom, second double bedroom, modern fitted and tiled bathroom, and hallway storage. The development boasts a 24 hour concierge, communal gardens, a roof terrace, convenience store and a private dentist.



These particulars, whilst believed to be accurate are set out as a general outline only for guidance and do not constitute any part of an offer or contract. Intending purchasers should not rely on them as statements of representation of fact, but must satisfy themselves by inspection or otherwise as to their accuracy. No person in this firm's employment has the authority to make or give any representation or warranty in respect of the property.

43 Loampit Vale, Lewisham, London, SE13 7FT

Tel: 020 3946 6200 Email: lewisham@madisonbrook.com <https://madisonbrook.com/>

Floor Plan

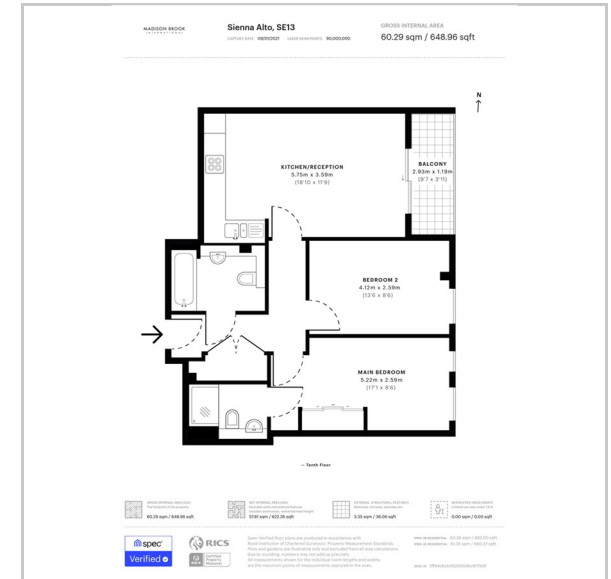

Area Map

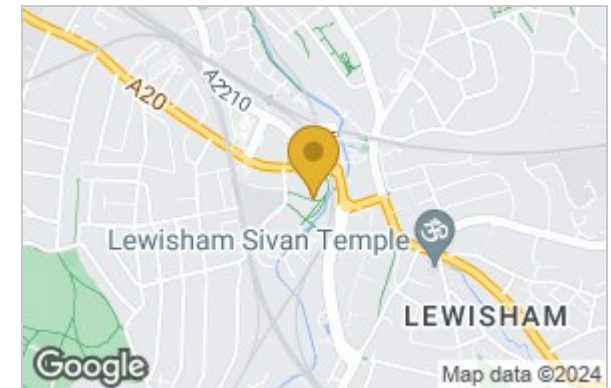

Energy Efficiency Graph

