

Living
made
better

2 Cornmill Lane
London, SE13 7FY

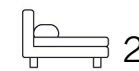

2



1



1



B

Offers In Excess Of £390,000

2 Cornmill Lane, London SE13 7FY

Madison Brook

A well presented two double bedroom apartment facing the quiet side of Cornmill Gardens offered with no chain.

Situated on the eighth floor, this well proportioned property comprises of a stylish fully fitted kitchen with built-in appliances and an open-plan lounge which boasts plenty of natural light and an access to a private balcony.

The apartment also offers two double bedrooms and a three piece bathroom suite with built-in storage. The property further benefits from an access to 1Gbps internet connectivity.

The development includes a 24-hour concierge service and two private communal terraces with breath-taking views over London's skyline. With the Lewisham Gateway at your doorstep, there are plenty of amenities nearby and Blackheath Common and Greenwich Park are only a short walk away.



Floorplan

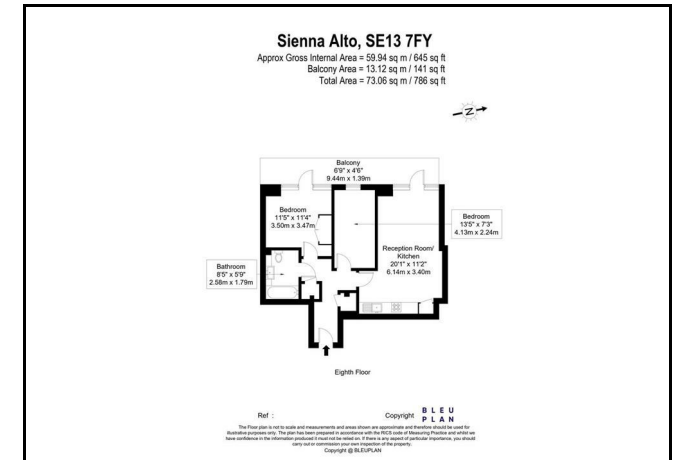

Area Map

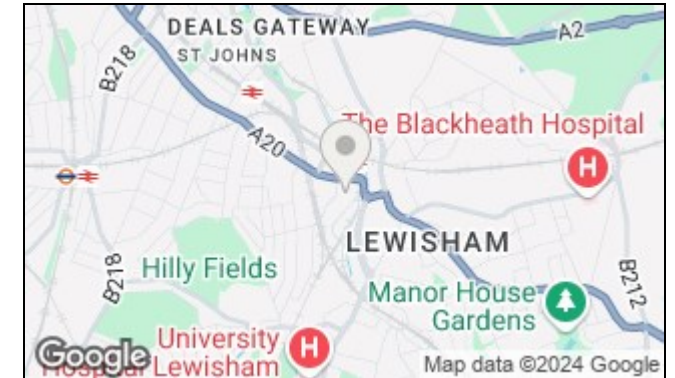

Energy Efficiency Graph

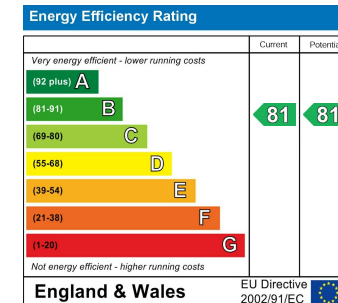

These particulars, whilst believed to be accurate are set out as a general outline only for guidance and do not constitute any part of an offer or contract. Intending purchasers should not rely on them as statements of representation of fact, but must satisfy themselves by inspection or otherwise as to their accuracy. No person in this firm's employment has the authority to make or give any representation or warranty in respect of the property.

43 Loampit Vale, Lewisham, London, SE13 7FT

Tel: 020 3946 6200 Email: lewisham@madisonbrook.com <https://madisonbrook.com/>