

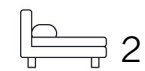

Living
made
better

Meadowside
London, SE9 6BS



Price Guide £400,000

Meadowside, London SE9 6BS

Madison Brook

Stunning & spacious, 2 bedroom, 2 bathroom third floor apartment set within the prestigious Berkeley Homes; Kidbrooke Village development and enjoying enviable views over the beautiful green open spaces of Sutcliffe Park.

There is a generous open plan living area, with a sleek fully integrated kitchen, leading out on to a smart balcony, there are 2 double bedrooms and the master has a sizeable built in wardrobe & impressive ensuite bathroom, as well as a separate family bathroom.

This beautiful, luxury apartment also benefits from a 24 hour concierge and residents gymnasium. The communal areas are superb and of the highest quality as are the impeccably maintained grounds.

Kidbrooke Station is only a short walk from the property as are the new shops and facilities currently being built especially for the development. Blackheath Village is



Floorplan

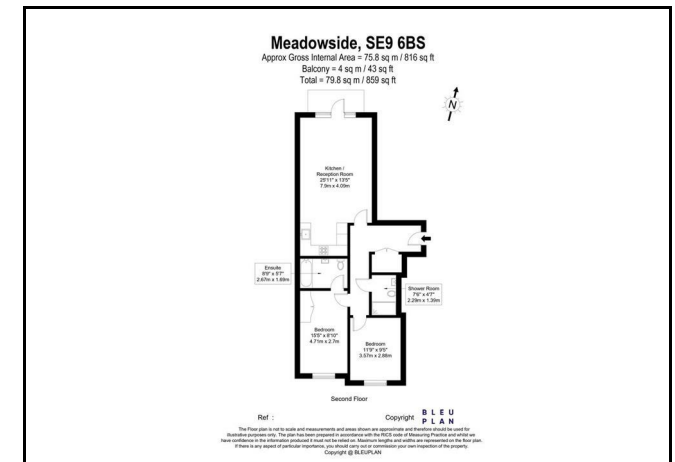

Area Map

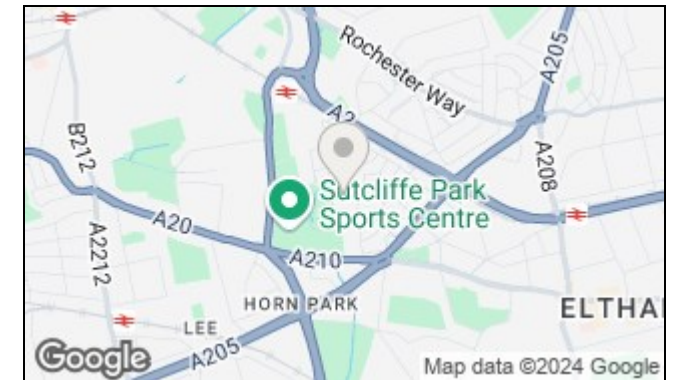

Energy Efficiency Graph

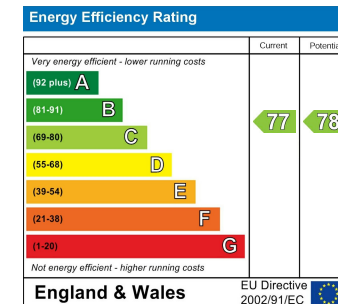

These particulars, whilst believed to be accurate are set out as a general outline only for guidance and do not constitute any part of an offer or contract. Intending purchasers should not rely on them as statements of representation of fact, but must satisfy themselves by inspection or otherwise as to their accuracy. No person in this firm's employment has the authority to make or give any representation or warranty in respect of the property.

43 Loampit Vale, Lewisham, London, SE13 7FT

Tel: 020 3946 6200 Email: lewisham@madisonbrook.com <https://madisonbrook.com/>