

Living
made
better

Loampit Vale
London, SE13 7TG

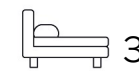

Offers In Excess Of £660,000

Loampit Vale, London SE13 7TG

Madison Brook

A well presented, spacious three bedroom apartment in SE13. Located on the fifth floor this apartment boasts a high specification throughout creating a desirable home in a great central location.

This spacious apartment boasts 1,287 square foot of internal space comprising of three spacious bedrooms (master with an en-suite). The open plan living arrangements are a great entertaining space, fully equipped with a stunning private terrace that extends the living space out further.

Centralis is ideally located with numerous train stations all under half a mile away, including Lewisham Station and DLR which offer excellent direct routes into a number of Central London's most popular destinations including: London Bridge, London Victoria, Charing Cross, Bank and Canary Wharf.

Located within the heart of the Lewisham regeneration, The Lewisham Gateway project which is currently underway to revitalise the Town Centre and shopping area



Floorplan

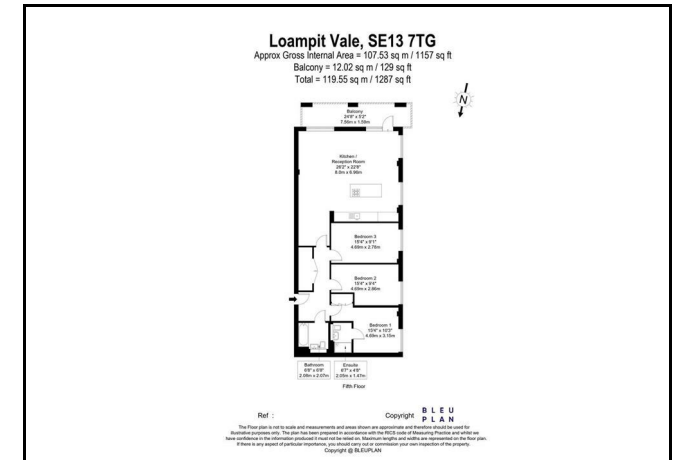

Area Map

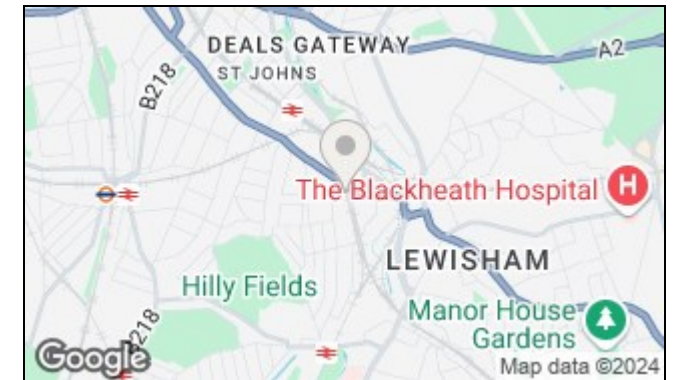

Energy Efficiency Graph

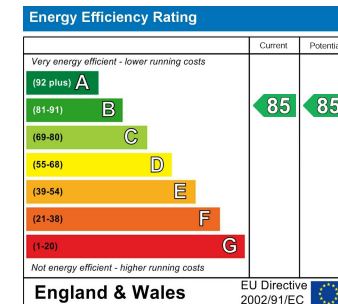

These particulars, whilst believed to be accurate are set out as a general outline only for guidance and do not constitute any part of an offer or contract. Intending purchasers should not rely on them as statements of representation of fact, but must satisfy themselves by inspection or otherwise as to their accuracy. No person in this firm's employment has the authority to make or give any representation or warranty in respect of the property.

43 Loampit Vale, Lewisham, London, SE13 7FT

Tel: 020 3946 6200 Email: lewisham@madisonbrook.com <https://madisonbrook.com/>