



# Loampit Hill

, Lewisham, SE13 7SW

Price Guide £350,000



**MADISON BROOK**  
INTERNATIONAL



# Loampit Hill, Lewisham, SE13 7SW

Being Sold via Secure Sale online bidding. Terms & Conditions apply. Starting Bid £350,000.

A Victorian classic two-bedroom flat in need of refurbishment.

Enter from the street through a raised, shared front garden. The communal ha leads you by stairs to the flat's first floor entrance. Once inside you will find a separate kitchen which faces rear with a large sash window, a bathroom and front aspect reception. A wide bay of sash windows peers down over the garden and there's an ornate period fireplace with decorative marble mantel. The first of the bedrooms shares the front spot with another sash window and picture rails. The second larger bedroom sits behind the reception with another period fireplace and plenty of room for both storage and a large double bed.

Central London is made easy with trains from Lewisham, or you can grab the DLR for Canary Wharf and more. Plenty of buses too to choose from (including lots of night routes).



These particulars, whilst believed to be accurate are set out as a general outline only for guidance and do not constitute any part of an offer or contract. Intending purchasers should not rely on them as statements of representation of fact, but must satisfy themselves by inspection or otherwise as to their accuracy. No person in this firms employment has the authority to make or give any representation or warranty in respect of the property.

43 Loampit Vale, Lewisham, London, SE13 7FT

Tel: 020 3946 6200 Email: lewisham@madisonbrook.com <https://madisonbrook.com/>

## Floor Plan

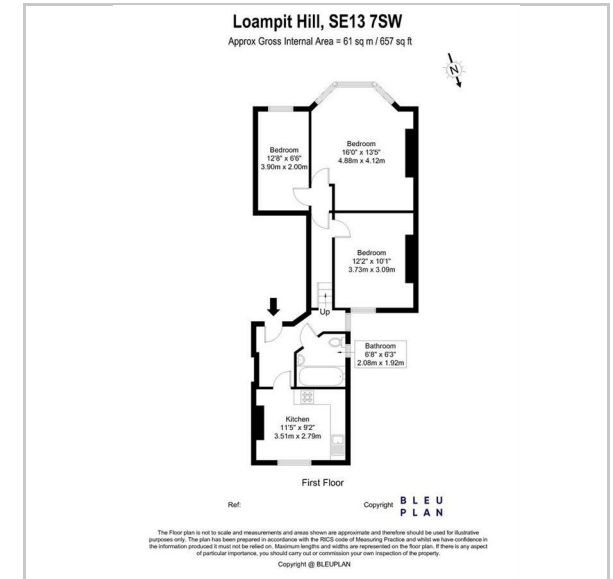

## Area Map

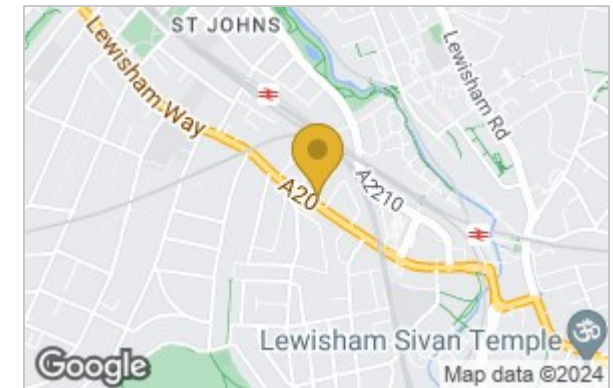

## Energy Efficiency Graph

