



Sydney Road  
London, SE2 9RX

Price Guide £300,000



**MADISON BROOK**  
INTERNATIONAL



# Sydney Road, London, SE2 9RX

Being Sold via Secure Sale online bidding. Terms & Conditions apply. Starting Bid £300,000

Semi-detached bungalow located just a 0.2miles from Abbey Wood Elizabeth Line and Mainline Train Station. The property comes with a planning permission for erection of single storey rear extension and a loft conversion.

The accommodation comprises a porch, entrance hall, a living room / bedroom, a reception / dining room leading to a separate kitchen and a three-piece bathroom suite. A sun-room beyond the kitchen extends the ground floor accommodation which leads to the Rear Garden.

Externally, there's a driveway to front offering off road parking and a sizeable-rear garden of approximately 92ft width, and depth extending to approximately 76ft.



These particulars, whilst believed to be accurate are set out as a general outline only for guidance and do not constitute any part of an offer or contract. Intending purchasers should not rely on them as statements of representation of fact, but must satisfy themselves by inspection or otherwise as to their accuracy. No person in this firms employment has the authority to make or give any representation or warranty in respect of the property.

43 Loampit Vale, Lewisham, London, SE13 7FT

Tel: 020 3946 6200 Email: lewisham@madisonbrook.com <https://madisonbrook.com/>

## Floor Plan

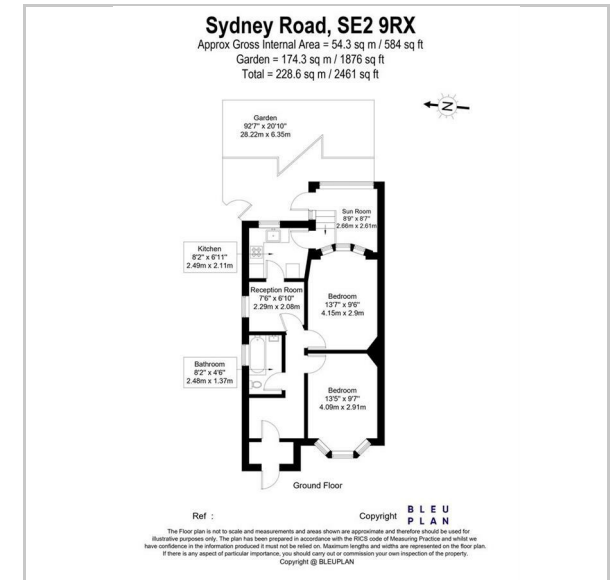

## Area Map

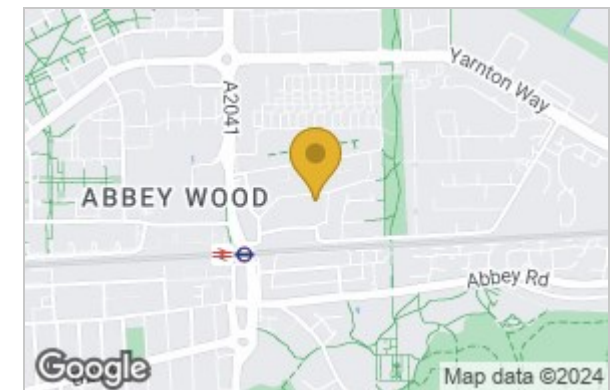

## Energy Efficiency Graph

