



15 Bessemer Place
North Greenwich, London, SE10 0GQ
Offers In Excess Of £400,000



MADISON BROOK
INTERNATIONAL

15 Bessemer Place, North Greenwich, London, SE10 0GQ

This spacious one bedroom apartment is ideally located on the Greenwich Peninsula moments from the wealth of amenities in the O2 arena. Whilst the location is great, the development also benefits from access to the resident's gym and concierge service.

This 5th floor apartment boasts 537 sq. ft. and comprises of a wonderful living space with access to a good sized balcony, as well as a fully-fitted open-plan kitchen, a well-proportioned master bedroom and modern bathroom.

For commuters, North Greenwich Underground Station (Jubilee Line) is only 0.6 miles away, as well as the Emirates Cable Car making The City of London and beyond easily accessible.



Floor Plan

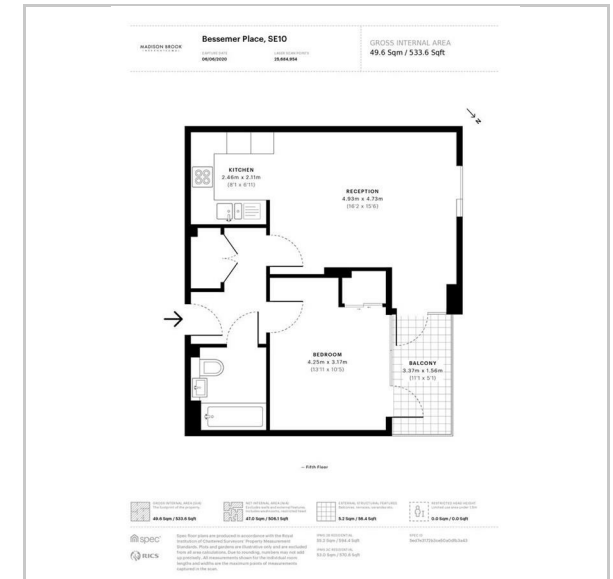

Area Map

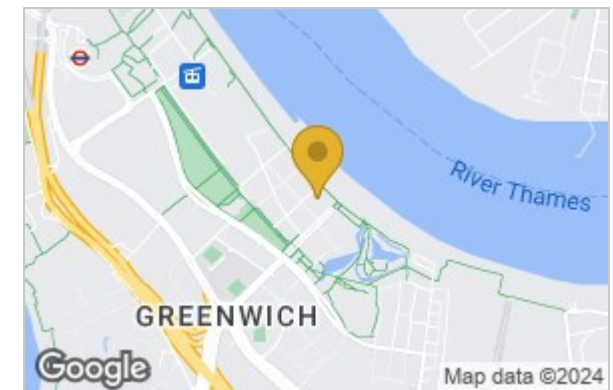

Energy Efficiency Graph

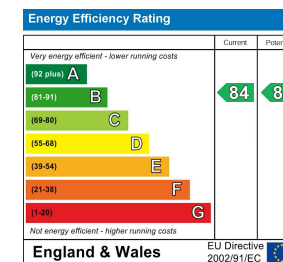

These particulars, whilst believed to be accurate are set out as a general outline only for guidance and do not constitute any part of an offer or contract. Intending purchasers should not rely on them as statements of representation of fact, but must satisfy themselves by inspection or otherwise as to their accuracy. No person in this firm's employment has the authority to make or give any representation or warranty in respect of the property.

43 Loampit Vale, Lewisham, London, SE13 7FT

Tel: 020 3946 6200 Email: lewisham@madisonbrook.com <https://madisonbrook.com/>