



Elmira Street
, London, SE13 7FW
£2,200 PCM



MADISON BROOK
INTERNATIONAL

Elmira Street, London, SE13 7FW

This beautifully presented two bedroom apartment is located on the sixth floor of Venice Corte, forming part of the popular Renaissance development.

Set over 754 Sq. Ft of internal space, the property comprises of a bright, airy living room offering access to private balcony overlooking the manicured communal garden and a contemporary open plan kitchen fitted with a range of integrated appliances; a generously sized principal bedroom with a stylish En-suite, an additional well proportioned double bedroom, a further chic family bathroom suite and ample storage to hallway.

Ideally situated for the commuter, Venice Corte is just a moments' walk to Lewisham Station (DLR & Southeastern) which provides a seamless journey into Canary Wharf & Central London. Residents can enjoy use of a 24 Hour Concierge, communal roof terrace, access to a range of local amenities and stunning walks across Greenwich & Blackheath.



These particulars, whilst believed to be accurate are set out as a general outline only for guidance and do not constitute any part of an offer or contract. Intending purchasers should not rely on them as statements of representation of fact, but must satisfy themselves by inspection or otherwise as to their accuracy. No person in this firm's employment has the authority to make or give any representation or warranty in respect of the property.

43 Loampit Vale, Lewisham, London, SE13 7FT

Tel: 020 3946 6200 Email: lewisham@madisonbrook.com <https://madisonbrook.com/>

Floor Plan

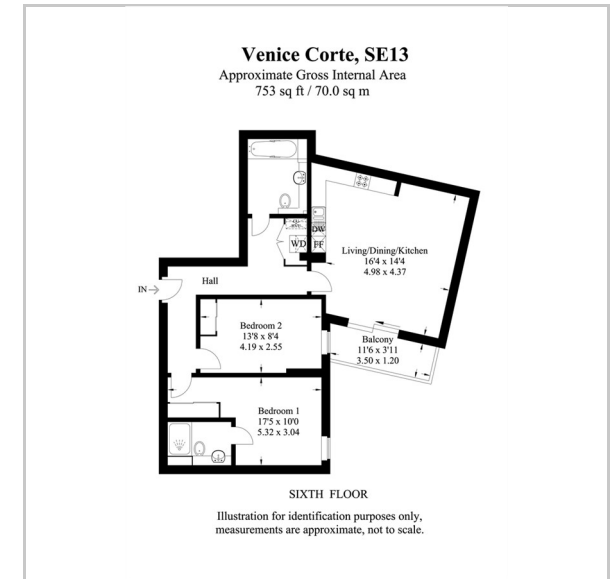

Area Map

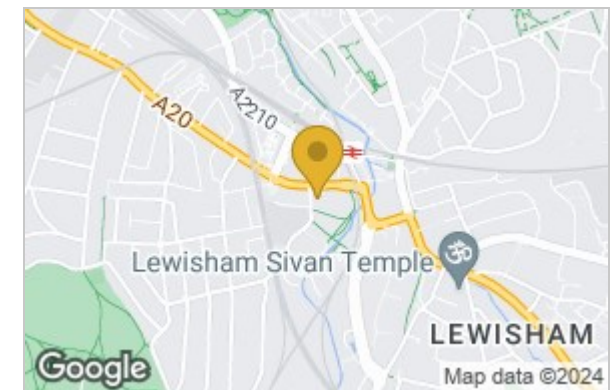

Energy Efficiency Graph

