



Goodwin Close  
, London, SE16 3TL

By Auction **£180,000**



**MADISON BROOK**  
INTERNATIONAL

# Goodwin Close, London, SE16 3TL

Being Sold via Secure Sale online bidding. Terms & Conditions apply. Starting Bid £180,000

Cash buyers only.

This one bedroom apartment is located on the top floor of Goodwin Close.

Set over 399 Sq. Ft of internal space, the property offers a bright, charming living space and a semi open plan kitchen space which has been equipped with a range of appliances; a generously sized principal bedroom, a chic shower suite and ample storage to the hallway.

Goodwin Close is ideally located for the commuter offering direct access to the Jubilee line via Bermondsey Station.



These particulars, whilst believed to be accurate are set out as a general outline only for guidance and do not constitute any part of an offer or contract. Intending purchasers should not rely on them as statements of representation of fact, but must satisfy themselves by inspection or otherwise as to their accuracy. No person in this firm's employment has the authority to make or give any representation or warranty in respect of the property.

43 Loampit Vale, Lewisham, London, SE13 7FT

Tel: 020 3946 6200 Email: lewisham@madisonbrook.com <https://madisonbrook.com/>

## Floor Plan

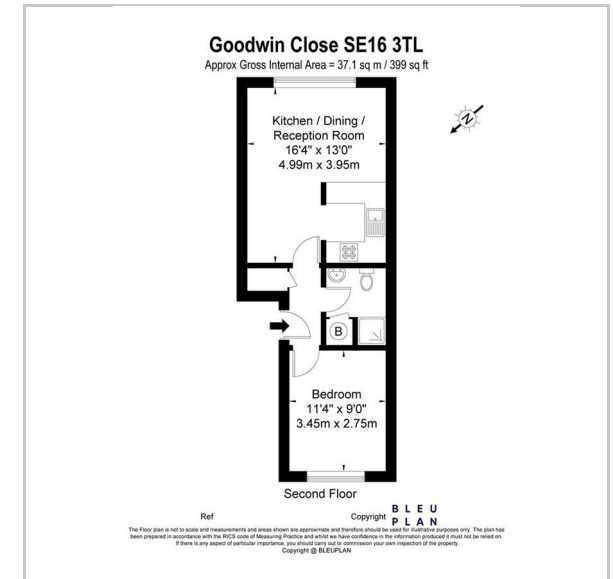

## Area Map

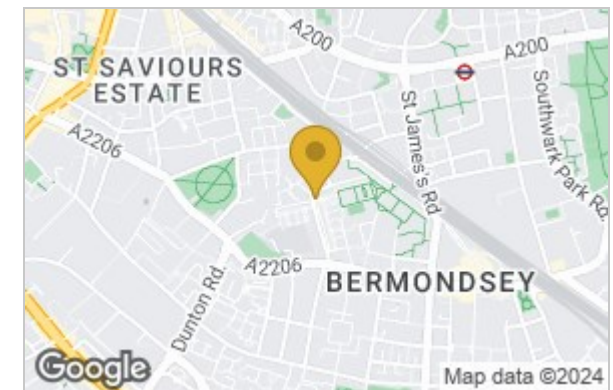

## Energy Efficiency Graph

