



Horseferry Place
Greenwich, London, SE10 9BB
Asking Price £565,000



MADISON BROOK
INTERNATIONAL

Horseferry Place, Greenwich, London, SE10 9BB

This immaculate two bedroom apartment is located on the first floor of the popular riverside development, Wood Wharf.

Set over 679 Sq. Ft of internal space, the property comprises a bright, airy living room finished with wooden flooring and a modern open plan kitchen fitted with a range of integrated appliances; a principle bedroom equipped with built in wardrobes and partial views of the River Thames, a further double bedroom and stylish family bathroom suite. The property offers access to three separate Juliet balconies, use of a private parking space within the secure underground car park and an onsite concierge service.

Surrounded by Greenwich's impressive selection of dining and entertainment facilities, the development is also conveniently located for commuting into Canary Wharf and the City. Local stations include Cutty Sark (DLR) & Greenwich (DLR & South Eastern).



These particulars, whilst believed to be accurate are set out as a general outline only for guidance and do not constitute any part of an offer or contract. Intending purchasers should not rely on them as statements of representation of fact, but must satisfy themselves by inspection or otherwise as to their accuracy. No person in this firm's employment has the authority to make or give any representation or warranty in respect of the property.

43 Loampit Vale, Lewisham, London, SE13 7FT

Tel: 020 3946 6200 Email: lewisham@madisonbrook.com <https://madisonbrook.com/>

Floor Plan

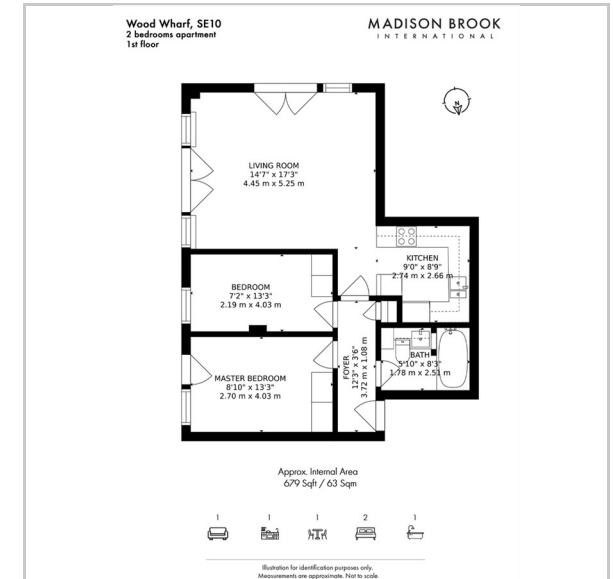

Area Map

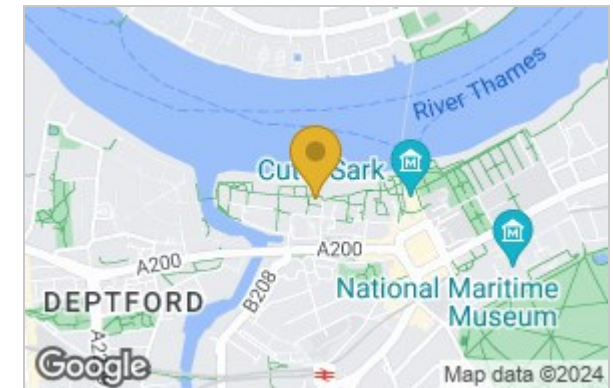

Energy Efficiency Graph

