



Sienna Alto
Lewisham, SE13

Asking Price £415,000



MADISON BROOK
INTERNATIONAL

Sienna Alto, Lewisham, SE13

Situated on the fourth floor, this well presented property comprises of a stylish fully fitted kitchen with built-in appliances and an open-plan lounge which boasts plenty of natural light and an access to a private balcony.

The apartment also offers two double bedrooms (master with an en-suite shower) and a three piece bathroom suite with built-in storage.

The development includes a 24-hour concierge service and two private communal terraces with breath-taking views over London's skyline. With the Lewisham Gateway at your doorstep, there are plenty of amenities nearby and Blackheath Common and Greenwich Park are only a short walk away.

Sienna Alto is conveniently located for Lewisham DLR and Train Stations with easy commute into London Bridge and Canary Wharf.



These particulars, whilst believed to be accurate are set out as a general outline only for guidance and do not constitute any part of an offer or contract. Intending purchasers should not rely on them as statements of representation of fact, but must satisfy themselves by inspection or otherwise as to their accuracy. No person in this firm's employment has the authority to make or give any representation or warranty in respect of the property.

43 Loampit Vale, Lewisham, London, SE13 7FT

Tel: 020 3946 6200 Email: lewisham@madisonbrook.com <https://madisonbrook.com/>

Floor Plan

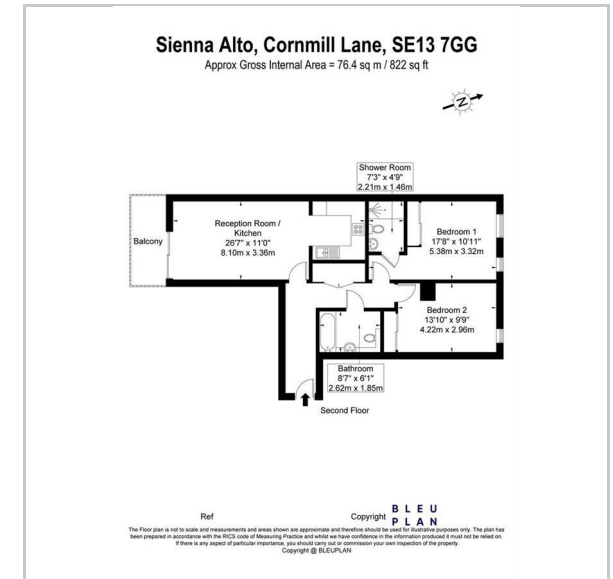

Area Map

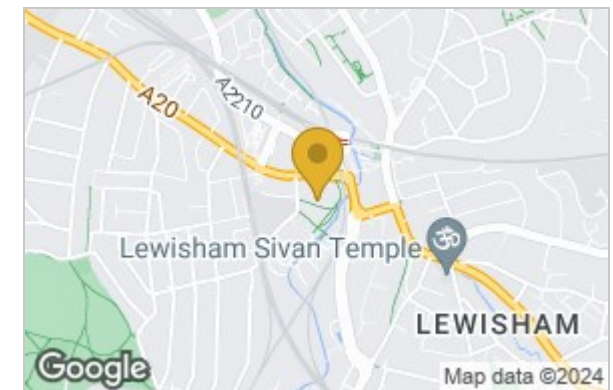

Energy Efficiency Graph

