







1 Ottley Drive  
Kidbrooke Village, London, SE3 9FP  
Asking Price £350,000

 1  1  1  B

**MADISON BROOK**  
INTERNATIONAL

# 1 Ottley Drive, Kidbrooke Village, London, SE3 9FP

Madison Brook is delighted to offer to the market this stunning one bedroom apartment. Located on the sixth floor of Grayston House, just 0.4 miles from Kidbrooke Station. The development benefits from a 24 hour concierge service and an exclusive residents' gymnasium.

The apartment comprises a bright & spacious reception with an open-plan, fully fitted kitchen including integrated appliances, leading out on to a private balcony overlooking the picturesque Sutcliffe Park. There is also a well proportioned master bedroom with built in wardrobes, as well as an elegant family bathroom & additional storage space to the hallway. The property further benefits from a secured gated parking space.

Grayston House is located in the Kidbrooke Village development, which is constructed by the Award Winning developer Berkley Homes. Close to Blackheath Park, Cator Park & Kidbrooke (Overground) Station.



These particulars, whilst believed to be accurate are set out as a general outline only for guidance and do not constitute any part of an offer or contract. Intending purchasers should not rely on them as statements of representation of fact, but must satisfy themselves by inspection or otherwise as to their accuracy. No person in this firm's employment has the authority to make or give any representation or warranty in respect of the property.

43 Loampit Vale, Lewisham, London, SE13 7FT

Tel: 020 3946 6200 Email: [lewisham@madisonbrook.com](mailto:lewisham@madisonbrook.com) <https://madisonbrook.com/>

## Floor Plan

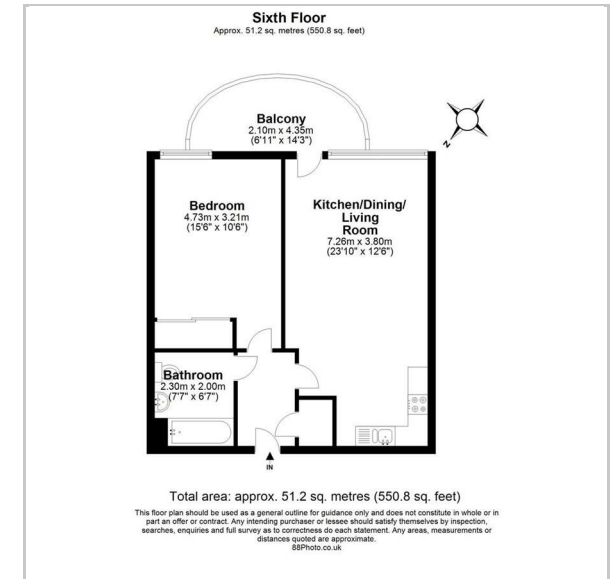

## Area Map

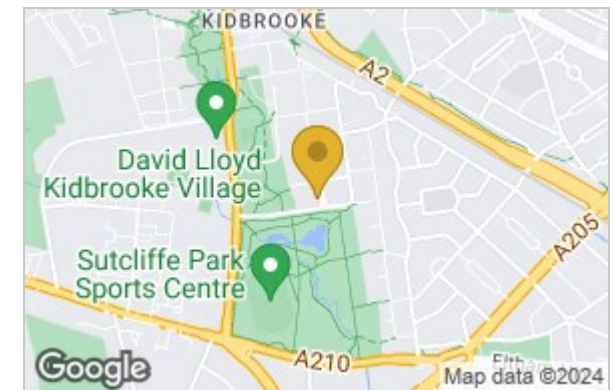

## Energy Efficiency Graph

