



Threadneedle House  
Lewisham, SE13

Offers In Excess Of £500,000



**MADISON BROOK**  
INTERNATIONAL

# Middleton Way, Lewisham, London, SE13 5FX

A beautiful and bright three bedroom, two bathroom flat located in Threadneedle House in Lewisham. Well positioned just off Belmont Park and perfect for access to Lewisham and Blackheath.

Internally spanning nearly 1000 Sq. Ft. with a wonderful airy feel to the property and floor to ceiling windows. There is a spacious open plan living room and kitchen with modern built-in appliances including a dishwasher, washing machine, oven, hob, hood and microwave. A three piece bathroom suite as well as the master bedroom with an en suite bathroom. Plenty of storage throughout, hardwood flooring, double glazing and spotlights to the ceiling.

A private West facing balcony with views on to the Belmont Park and the beautiful period homes.

The property is built in 2019 and in very good condition. There is also a lift in the building, and this flat offers a sheltered parking space as well.



These particulars, whilst believed to be accurate are set out as a general outline only for guidance and do not constitute any part of an offer or contract. Intending purchasers should not rely on them as statements of representation of fact, but must satisfy themselves by inspection or otherwise as to their accuracy. No person in this firm's employment has the authority to make or give any representation or warranty in respect of the property.

43 Loampit Vale, Lewisham, London, SE13 7FT

Tel: 020 3946 6200 Email: lewisham@madisonbrook.com <https://madisonbrook.com/>

## Floor Plan

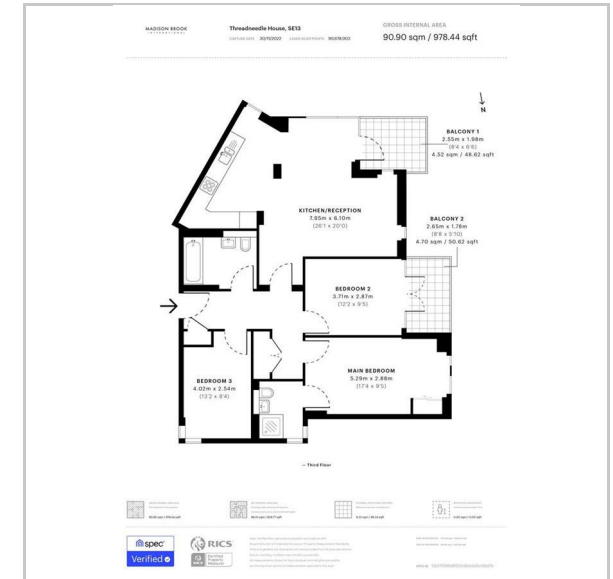

## Area Map

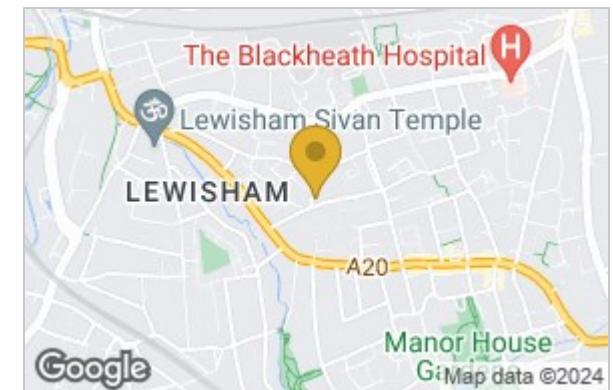

## Energy Efficiency Graph

