



32 Belmont Hill  
Lewisham, London, SE13 5AZ  
Offers In Excess Of £350,000



**MADISON BROOK**  
INTERNATIONAL

# 32 Belmont Hill, Lewisham, London, SE13 5AZ

OPEN HOUSE ON SATURDAY 6TH JANUARY - By appointment only between 2pm - 4pm

A spacious two double bedroom modern apartment within a gated development conveniently located between Blackheath Village and Lewisham Station and DLR.

The accommodation comprises; a large entrance hall with storage cupboards, a separate modern kitchen and a 15'1 x 15'1 reception room. There are two double bedrooms with the master having built in wardrobes and a fully-tiled, three piece suite bathroom. Additionally, the property benefits from its own garage and additional parking space and a very large communal garden.

The property is in a very convenient location and is perfect for the commute into the City, West End or Canary Wharf with Lewisham Station and DLR within 0.38 miles and Blackheath Station 0.59 miles. Lewisham station gives direct access to London Bridge, Cannon Street, Waterloo East, Charing Cross and Victoria as well as Canary Wharf and Bank on the DLR. The popular open spaces of Blackheath Common, (0.48 miles), Greenwich Park, (1.13 miles), Hilly Fields, (1.12 miles) and Manor House Gardens, (1.02 miles), are all within a short distance. An extensive fruit and veg market, plus the well-used street food Model Market are just minutes away, and there are several popular primary schools close by. Blackheath Village with its array of bars, restaurants and boutique shops is just a short walk away.



These particulars, whilst believed to be accurate are set out as a general outline only for guidance and do not constitute any part of an offer or contract. Intending purchasers should not rely on them as statements of representation of fact, but must satisfy themselves by inspection or otherwise as to their accuracy. No person in this firm's employment has the authority to make or give any representation or warranty in respect of the property.

43 Loampit Vale, Lewisham, London, SE13 7FT

Tel: 020 3946 6200 Email: lewisham@madisonbrook.com <https://madisonbrook.com/>

## Floor Plan

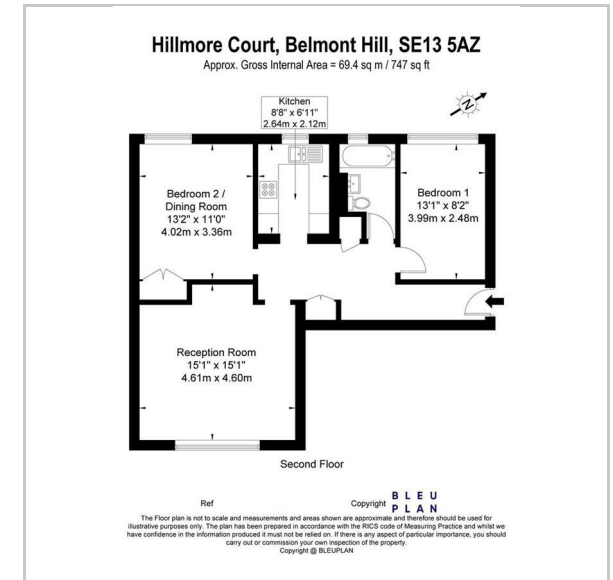

## Area Map

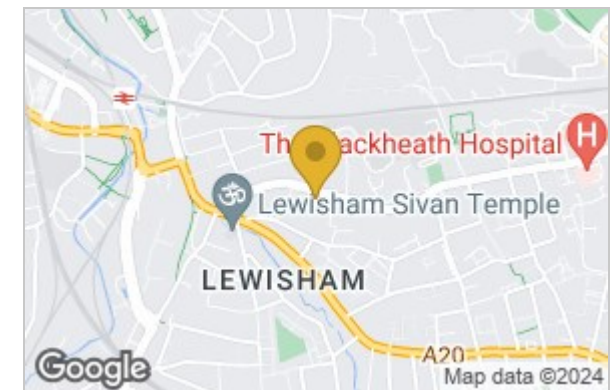

## Energy Efficiency Graph

