



Admirals Tower, Dowells Street
Greenwich, London, SE10 9FQ
Guide Price £625,000



MADISON BROOK
INTERNATIONAL

Admirals Tower, Dowells Street, Greenwich, London, SE10 9FQ

This spectacular two-bedroom apartment is available within Admirals Tower and is offered to the market chainfree.

Offering flawless views of the creek which leads on to the River Thames and Canary Wharf. A private West facing balcony stretching along the living room and a further 970 Sq. Ft. of internal space, the property comprises of a bright, spacious living room and an open plan kitchen fitted with a range of integrated appliances; a sizeable principal bedroom fitted with a stylish En-suite shower room, and a further well-proportioned double bedroom, additional chic family bathroom and storage unit to the hallway. Secure underground parking is also included.

Situated within the New Capital Quay Development, you also benefit from a number of onsite facilities including the 24 Hour Concierge Service, Waitrose & Costa Coffee. The development is also conveniently located for commuting into Canary Wharf and the City, using Cutty Sark (DLR) & Greenwich (DLR & South Eastern) both of which are a moments walk away.



Floor Plan

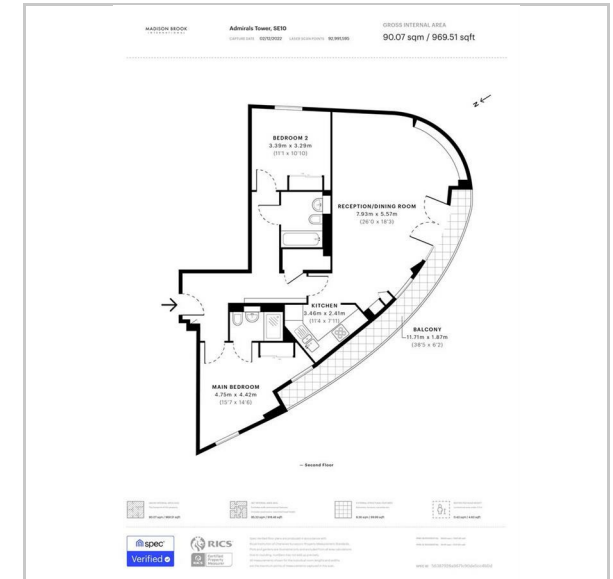

Area Map

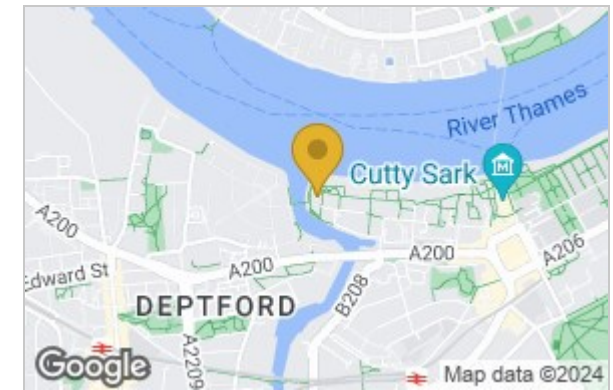

Energy Efficiency Graph

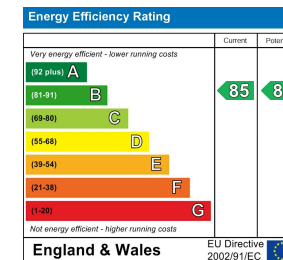

These particulars, whilst believed to be accurate are set out as a general outline only for guidance and do not constitute any part of an offer or contract. Intending purchasers should not rely on them as statements of representation of fact, but must satisfy themselves by inspection or otherwise as to their accuracy. No person in this firm's employment has the authority to make or give any representation or warranty in respect of the property.

43 Loampit Vale, Lewisham, London, SE13 7FT

Tel: 020 3946 6200 Email: lewisham@madisonbrook.com <https://madisonbrook.com/>