



 1
Bedroom

 1
Bathroom

BREE COURT

LASTING
REMARKING
APARTMENTS



Warren Bradley Estates are delighted to offer for sale this stunning 1 bedroom apartment on the 4th floor within the TNQ development in Colindale which is located close to all local amenities including various supermarkets, leisure facilities and green spaces. The property benefits from a large lounge which leads to a modern fully fitted kitchen at one end and a balcony at the other. There is also a spacious bedroom with built in wardrobes and a fully tiled bathroom.

Externally the property benefits from an allocated car parking space within the underground secure car park, a lift and landscaped communal gardens. Ideal for first time buyers or rental investors alike, call now for an immediate appointment.

Entrance Hall

2.40m x 2.00m (7' 10" x 6' 7")

Reception

4.50m x 4.00m (14' 9" x 13' 1")

Kitchen

2.60m x 2.00m (8' 6" x 6' 7")

Balcony

2.70m x 1.50m (8' 10" x 4' 11")

Bedroom

4.50m x 3.00m (14' 9" x 9' 10")

Bathroom

2.00m x 2.00m (6' 7" x 6' 7")

Allocated Parking

Allocated space within the secure car park

Leasehold

125 years from March 2016 (116 Years remaining) - As advised by Vendor, documents not seen

Service Charge

£3029.16 Per Annum - As advised by Vendor, documents not seen

Ground Rent

£250.00 Per Annum - As advised by Vendor, documents not seen

Bree Court

Approx. 48.2 sq. metres (518.4 sq. feet)

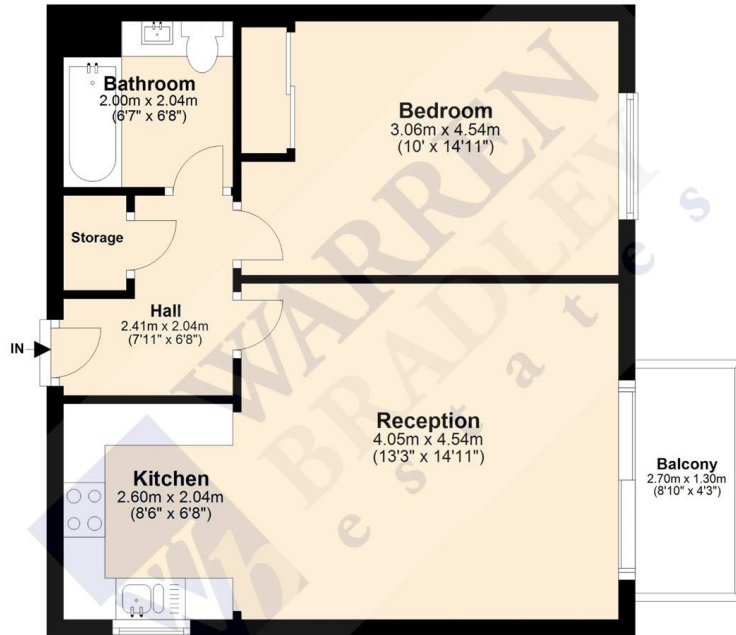

Total area: approx. 48.2 sq. metres (518.4 sq. feet)

Disclaimer: Please note this floor plan is for marketing purposes and is to be used as a guide only.
Plan produced using PlanUp.

Score	Energy rating	Current	Potential
92+	A		
81-91	B	83 B	83 B
69-80	C		
55-68	D		
39-54	E		
21-38	F		
1-20	G		

