



**Apt 7 Riverside Court, Linnpark Avenue, Netherlee G44 3PH**

[www.nicolestateagents.co.uk](http://www.nicolestateagents.co.uk)



Nicol Estate Agents





Nicol Estate Agents

## Situation

Netherlee and its neighbouring suburbs of Clarkston and Giffnock are acknowledged for its standard of local amenities and provides a selection of local shops, supermarkets, restaurants, regular bus and rail services to Glasgow City Centre, banks, library and health care facilities.

This property is conveniently located for Clarkston Road & Clarkston Toll amenities including local shops, supermarket, coffee shops catering for day to day requirements.

This popular suburb is located approximately 5 miles to the South of Glasgow's City Centre and is conveniently situated for commuter access to nearby M77/M8 & Glasgow Southern Orbital.

Sports and recreational facilities can be found locally to include Nuffield Health Club, Cathcart, Williamwood and Whitecraigs Golf Clubs and Linn Park, the second largest park in the city and with its variety of activities including an 18 hole golf course, children play areas and its extensive grounds offer woodland, river walks and Holmwood House, designed by one of Scotland's greatest Classical architects, Alexander 'Greek' Thomson (1817-1875) and is now maintained by the National Trust for Scotland.





Nicol Estate Agents

## Property Description

Seldom available, a well presented two bedroom, ground floor apartment located within continually popular retirement style development, close to local amenities and transport links on Clarkston Road

The property has been upgraded and well maintained by the present owners and comprises:

Communal entrance hallway with a door entry system. Reception hallway with storage. Bright and well presented sitting room overlooking the rear of the development. Access to kitchen. Well appointed refitted kitchen, with a range of wall mounted and floor standing units and complementary worktop surfaces. Bedroom one, with fitted wardrobes. Bedroom two with fitted wardrobes. The refitted shower completes the accommodation.

The property is further complemented by upgraded electric wet central heating, double glazing, well kept communal gardens and resident's lounge.

Residents and visitors parking provided.



[www.nicolestateagents.co.uk](http://www.nicolestateagents.co.uk)

**7 Riverside Court, Netherlee**  
Approximate Gross Internal Area 666 sq ft - 61.87 sq m

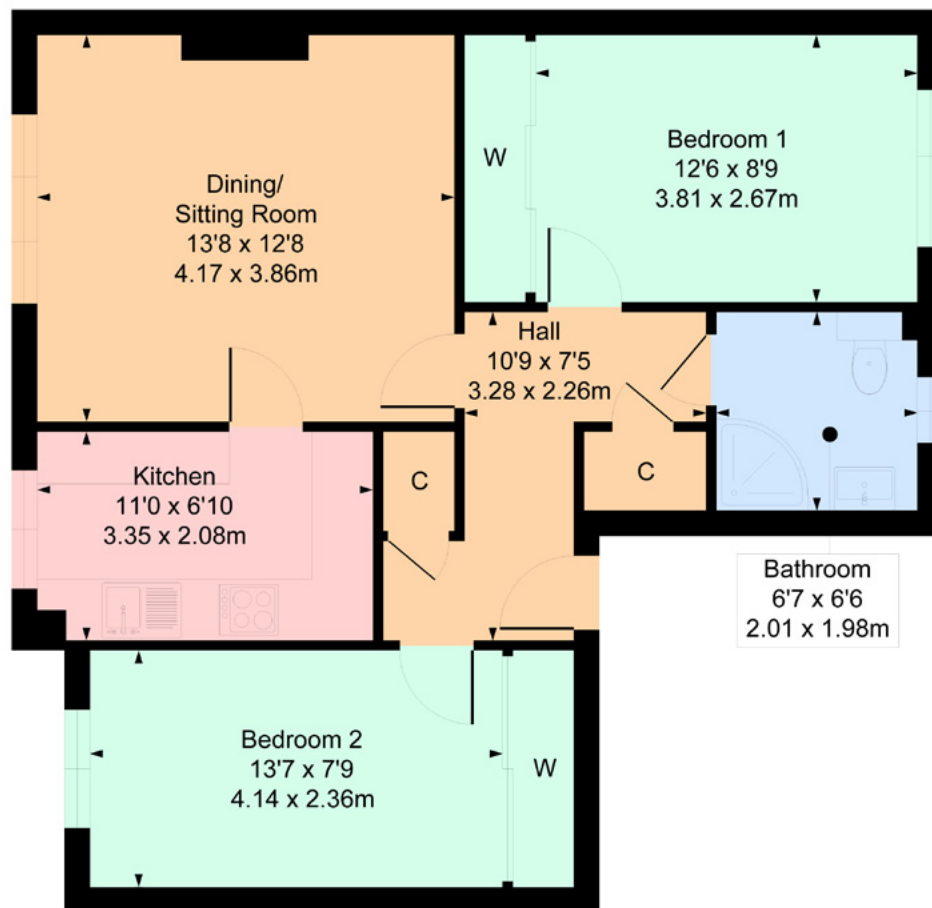

**SKETCH PLAN FOR ILLUSTRATIVE PURPOSES ONLY** All measurements, walls, doors, windows, fitting and appliances, their sizes and locations are approximate only. They cannot be regarded as being a representation by the seller, nor their agent. We believe these details to be accurate however it is not guaranteed and they do not form any part of a contract. Fixtures and fittings are not included unless specified in the enclosed. Photographs are for general information and it must not be inferred that any item is included for sale with the property.



**Nicol Estate Agents**

**Viewing**

By appointment through  
Nicol Estate Agents  
**Clarkston**

**Outgoings**

East Renfrewshire Council  
Band D

**Fixtures & Fittings**

Only items specifically mentioned in the sale particulars are included in the sale price.

**Energy Efficiency Rating**

Band C

**Services**

The property will be supplied by mains water, gas, electricity and drainage. .

**Local Authority**

**East Renfrewshire Council**  
**Council headquarters**  
**Eastwood Park**  
**Rouken Glen Road**  
**Giffnock**  
**G46 6UG**  
**Tel: (0141) 577 3000**

**Property Reference**

CLA587