



## Holmesdale Gardens, Hastings TN34 1LY

Offers in excess of £175,000



A well presented ONE BEDROOM APARTMENT located in a favoured and CENTRAL POSITION just a short stroll from Hastings seafront, the beach and town centre where there are a range of shopping facilities, eateries and a mainline railway station. The accommodation here is arranged as a BRIGHT LIVING ROOM which enjoys a rear aspect with VIEWS TOWARDS THE SEA and leads through to the MODERN FITTED KITCHEN where there is ample storage and worktop space. There is one double bedroom together with a STYLISH BATHROOM where there is a bath with shower over. Set in a CONVENIENT LOCATION, being sold with NO ONWARD CHAIN and a SHARE OF FREEHOLD, this fantastic property would make the PERFECT FIRST TIME HOME or seaside retreat and is not to be missed.

447 sq.ft. (41.6 sq.m.) approx.

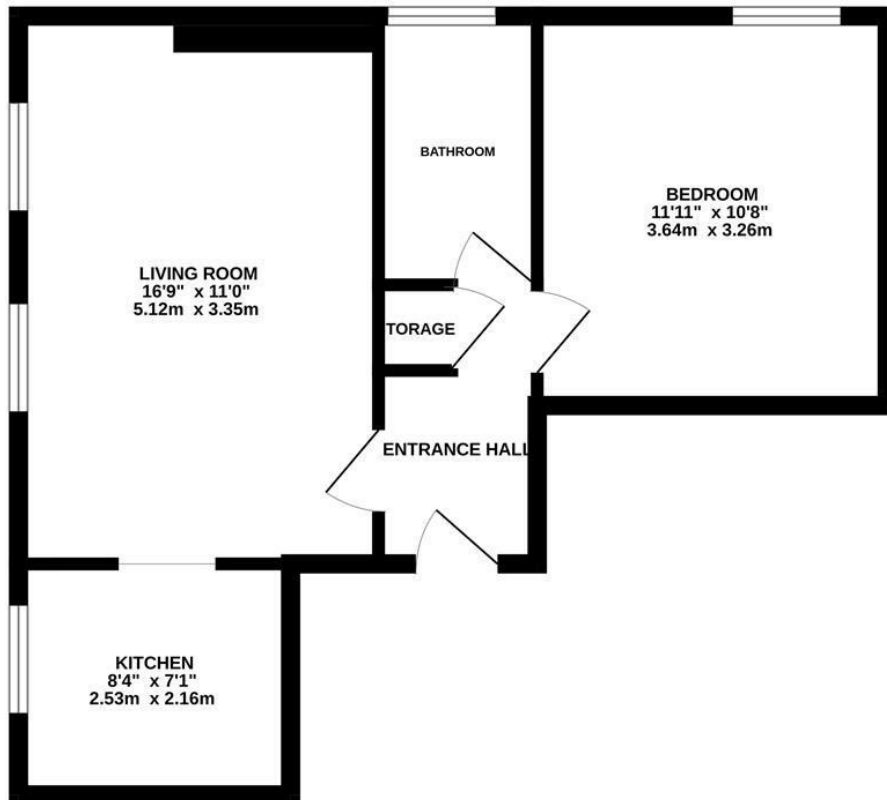

TOTAL FLOOR AREA: 447 sq.ft. (41.6 sq.m.) approx.

Whilst every attempt has been made to ensure the accuracy of the floorplan contained here, measurements of doors, windows, rooms and any other items are approximate and no responsibility is taken for any error, omission or mis-statement. This plan is for illustrative purposes only and should be used as such by any prospective purchaser. The services, systems and appliances shown have not been tested and no guarantee as to their operability or efficiency can be given.

Made with Metroplan ©2024

