

Marine Court, St. Leonards-On-Sea TN38 0DW

Offers in excess of £210,000



Exceptional two bedroom SEAFRONT APARTMENT with a PRIVATE SOUTHERLY FACING ENCLOSED BALCONY and BREATHTAKING SEA VIEWS set on the sixth floor of this iconic landmark in St Leonards. It's enviably positioned ADJACENT TO THE BEACH and just a short walk from central St. Leonards where there are independent shops, welcoming coffee shops, award winning eateries and a mainline railway station with connections to London. Enjoying a wealth of ORIGINAL ART DECO FEATURES, the accommodation here is arranged as a FITTED KITCHEN which offers ample storage and a bright OPEN PLAN LIVING AND DINING SPACE with large windows framing a front aspect and access out to the spacious balcony. There are TWO DOUBLE BEDROOMS with the main bedroom measuring an impressive 14'10 x 12'2 together with a STYLISH FAMILY BATHROOM where there is a bath with shower over. Set in an IDYLIC AND UNRIVALLED SETTING and being sold with a SHARE OF FREEHOLD and LONG LEASE this fantastic property is not to be missed.

SIXTH FLOOR
803 sq.ft. (74.6 sq.m.) approx.

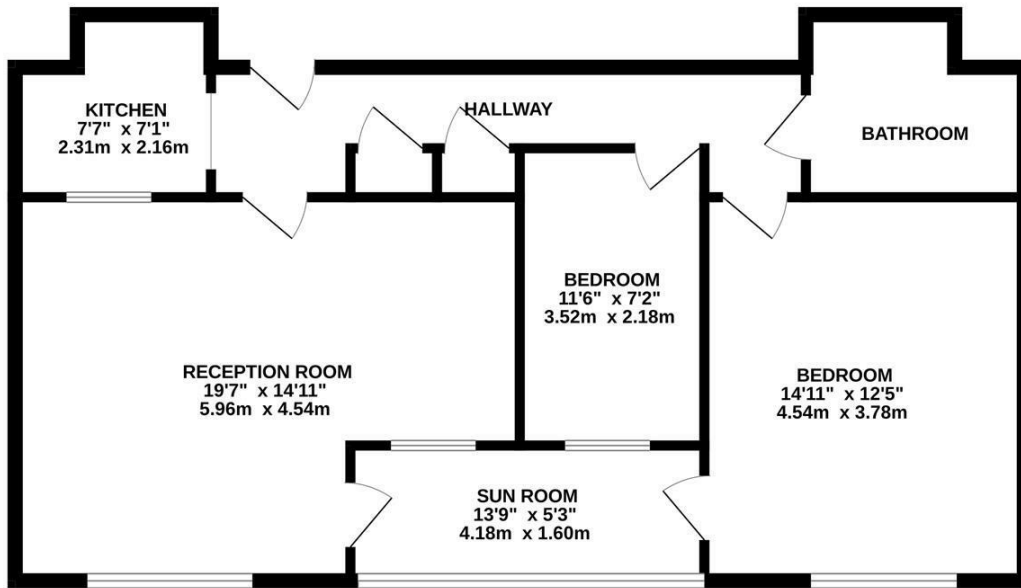

TOTAL FLOOR AREA : 803 sq.ft. (74.6 sq.m.) approx.

Whilst every attempt has been made to ensure the accuracy of the floorplan contained here, measurements of doors, windows, rooms and any other items are approximate and no responsibility is taken for any error, omission or mis-statement. This plan is for illustrative purposes only and should be used as such by any prospective purchaser. The services, systems and appliances shown have not been tested and no guarantee as to their operability or efficiency can be given.

Made with Metropix ©2023

