



Milward Road, Hastings TN34 3RT

Offers in excess of £220,000



Found elevated above the town this fantastic flat has panoramic views across to the sea and is only a 10 minute stroll down to the independent bars and cafes in the Old Town. This spacious home sits on the ground floor of a charming Victorian building and enjoys a private entrance and rear garden. The interior has been meticulously maintained by the current sellers, the sense of space they have created here is amazing, the high ceilings, expansive living area and the gorgeous eat in kitchen which is fully equipped for proper cooking makes this a super practical home.

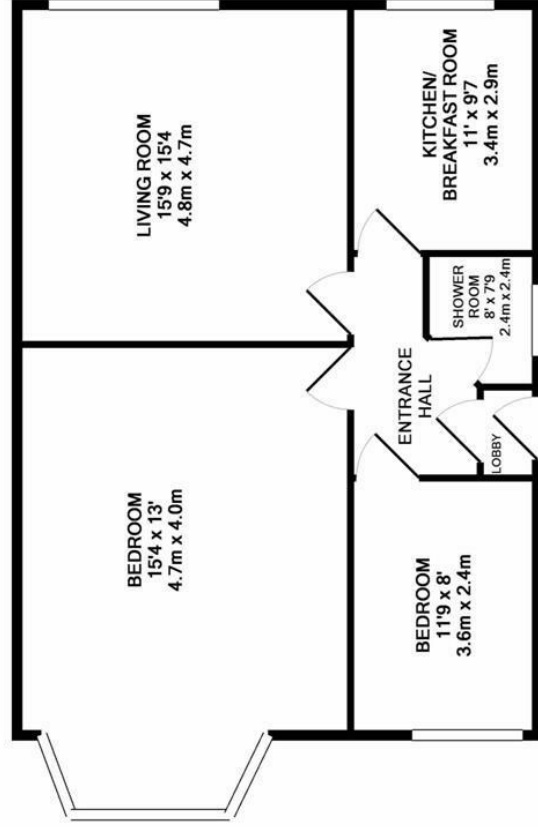

TOTAL APPROX. FLOOR AREA 840 SQ.FT. (78.1 SQ.M.)

Whilst every attempt has been made to ensure the accuracy of the floor plan contained here, measurements of doors, windows, rooms and any other items are approximate and no responsibility is taken for any error, omission, or mis-statement. This plan is for illustrative purposes only and should be used as such by any prospective purchaser. The services, systems and appliances shown have not been tested and no guarantee as to their operability or efficiency can be given.

Made with Metropix ©2017

