



## Uckham Lane, Battle TN33 0LZ

Offers in excess of £850,000



5



1



3



D

A unique three bedroom CONVERTED FORMER CATTLE SHED with various outbuildings including a triple car barn and bar occupying an idyllic position at the end of a winding lane set in a stunning countryside setting within two acres of private grounds. It's ideally positioned only a short drive from Battle High Street offering a range of shops and cafes, there is also a mainline railway station with connections to London and excellent local schools. Placed within an area of outstanding natural beauty, the accommodation here offers BREATHTAKING RURAL VIEWS and has been thoughtfully redesigned to provide the perfect blend of country charm and modern luxury. The main house is arranged as a bright, OPEN PLAN LIVING SPACE which measures an impressive 29'6 x 15'1 with a vast VAULTED CEILING and exposed wooden beams, there are three sets of double doors opening to a landscaped walled garden. The kitchen is FITTED WITH CONTEMPORARY UNITS housing ample storage and worktop space, there is also a CENTRAL ISLAND/BREAKFAST BAR to create a sociable space. There are three double bedrooms each enjoying BUILT-IN STORAGE together

GROUND FLOOR  
1679 sq.ft. (156.0 sq.m.) approx.

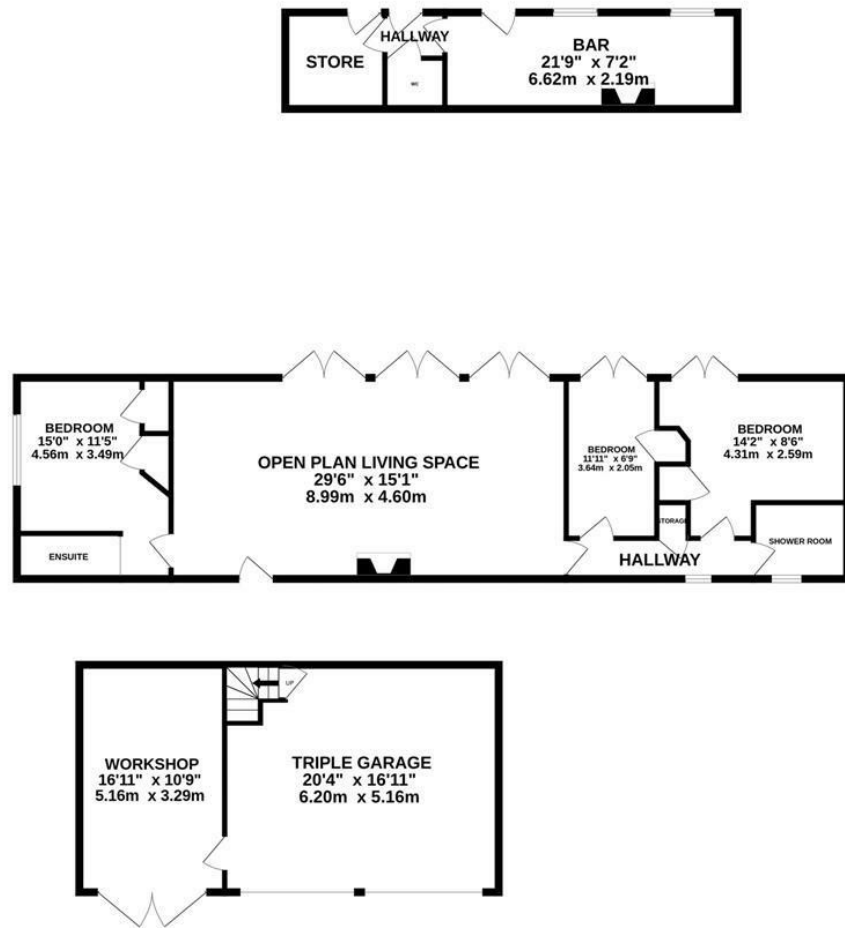

TOTAL FLOOR AREA: 1679 sq.ft. (156.0 sq.m.) approx.

Whilst every attempt has been made to ensure the accuracy of the floorplan contained here, measurements of doors, windows, rooms and any other items are approximate and no responsibility is taken for any error, omission or mis-statement. This plan is for illustrative purposes only and should be used as such by any prospective purchaser. The services, systems and appliances shown have not been tested and no guarantee as to their operability or efficiency can be given.  
Made with Metreplex ©2025

