



Ellenslea Road, St. Leonards-On-Sea TN37 6HY

Offers in excess of £175,000



2



1



1



D

A bright two bedroom GARDEN APARTMENT set on the hall floor of this PERIOD RESIDENCE in a leafy St. Leonards setting. It's within walking distance of local shops and Hastings Town centre, plus the hub of St. Leonards On Sea with its eateries and local shops, both with mainline railway stations and connections to London. The accommodation here is arranged as a BAY FRONTED LIVING ROOM which measures an impressive 18'4 x 11'7 while the FITTED KITCHEN/DINER is positioned at the rear offering ample storage space and access to the rear garden. There are two bedrooms with the principle bedroom enjoying a rear aspect together with a family bathroom where there is a bath with shower over. Externally the rear garden offers an area of patio off of the kitchen making this the perfect spot to DINE-ALFRESCO followed by a raised expanse of lawn. Being sold with NO ONWARD CHAIN, this fantastic property would make the perfect first time home or seaside retreat and is not to be missed.

HALL FLOOR  
671 sq.ft. (62.3 sq.m.) approx.

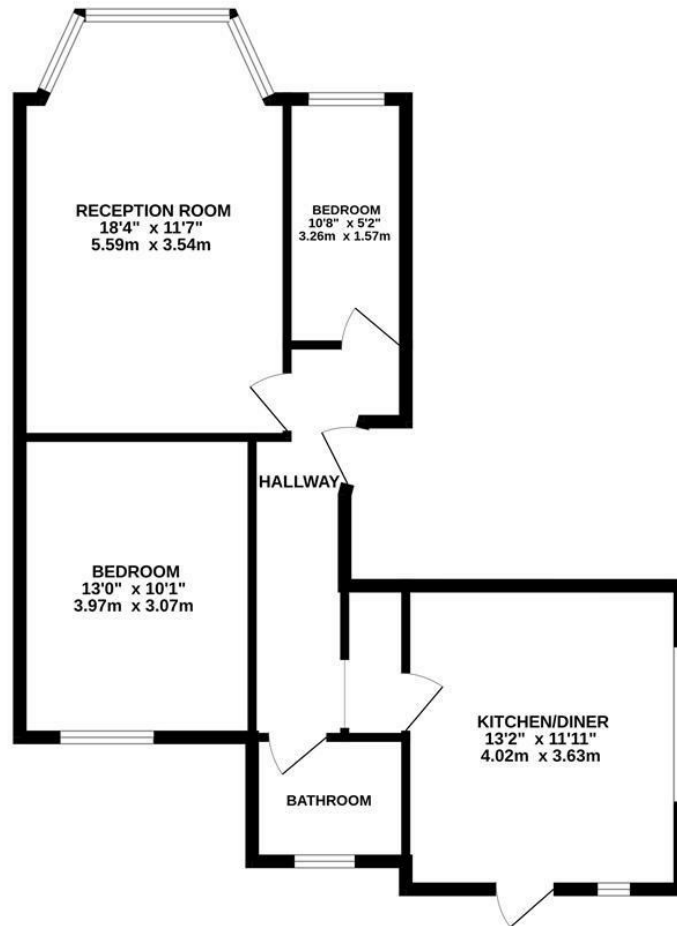

TOTAL FLOOR AREA : 671 sq.ft. (62.3 sq.m.) approx.

Whilst every attempt has been made to ensure the accuracy of the floorplan contained here, measurements of doors, windows, rooms and any other items are approximate and no responsibility is taken for any error, omission or mis-statement. This plan is for illustrative purposes only and should be used as such by any prospective purchaser. The services, systems and appliances shown have not been tested and no guarantee as to their operability or efficiency can be given.  
Made with Metropix ©2025

