



Linton Road, Hastings TN34 1TW

Offers in excess of £160,000



A bright one bedroom apartment situated on the FIRST FLOOR of this PERIOD RESIDENCE located in a central setting, just a short walk through Linton Gardens to the seafront and Hastings Town Centre where there is a range of shops, restaurants and a mainline railway station with connections to London. The accommodation here is arranged as a BAY FRONTED LIVING SPACE boasting STUNNING SEA VIEWS and offering plenty of space for a dining table while the SEPARATE KITCHEN is positioned at the rear of the property and enjoys ample storage space. The double bedroom benefits from a high ceiling and a FRONT ASPECT with three large sash windows overlooking the sea together with a family bathroom which features a bath with shower and screen over. Set in a SOUGHT AFTER LOCATION this fantastic property would make the PERFECT FIRST TIME HOME or SEASIDE RETREAT and is not to be missed.

FIRST FLOOR  
384 sq.ft. (35.7 sq.m.) approx.

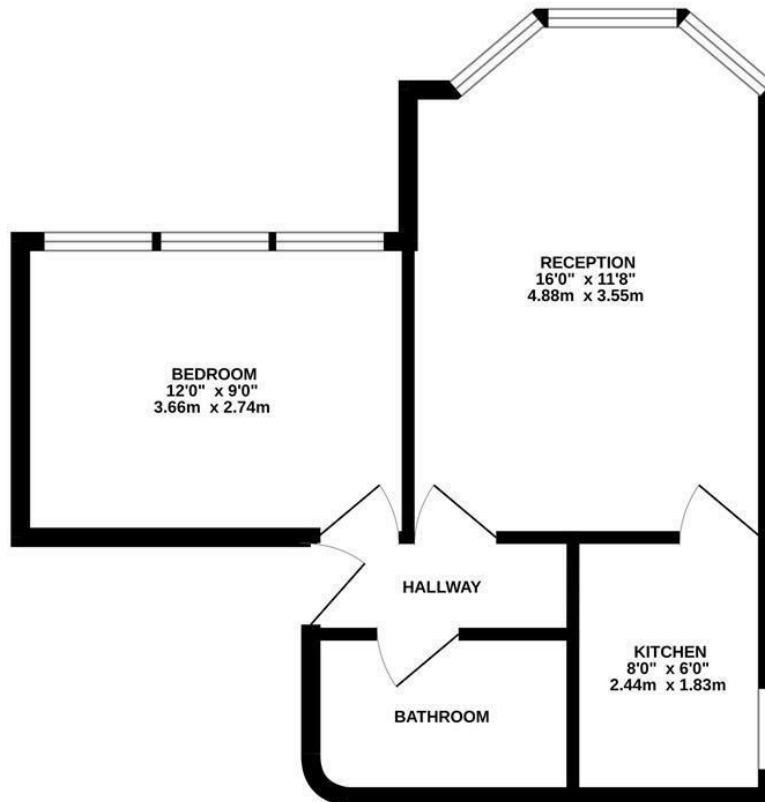

TOTAL FLOOR AREA : 384 sq.ft. (35.7 sq.m.) approx.

Whilst every attempt has been made to ensure the accuracy of the floorplan contained here, measurements of doors, windows, rooms and any other items are approximate and no responsibility is taken for any error, omission or mis-statement. This plan is for illustrative purposes only and should be used as such by any prospective purchaser. The services, systems and appliances shown have not been tested and no guarantee as to their operability or efficiency can be given.  
Made with Metropix ©2023

