

Laton Road, Hastings TN34 2ES

Offers in excess of £170,000



A bright TWO BEDROOM apartment positioned on the GROUND FLOOR of this attractive period residence located in a sought after, tree lined Road. It's within walking distance of Alexandra Park, good transport links and within easy reach of Hastings Town centre. Having been refurbished to a high standard throughout the accommodation here is beautifully presented and arranged as an OPEN PLAN LIVING space which features a STYLISH KITCHEN housing integrated appliances. There are two bedrooms together with a CONTEMPORARY BATHROOM. This fantastic property enjoys the use of communal gardens and RESIDENTS PARKING which is available on a first come first serve basis. Being sold with NO ONWARD CHAIN and a long lease this would make the perfect first time home or investment.

GROUND FLOOR 41.43 sq. m.
(445.96 sq. ft.)

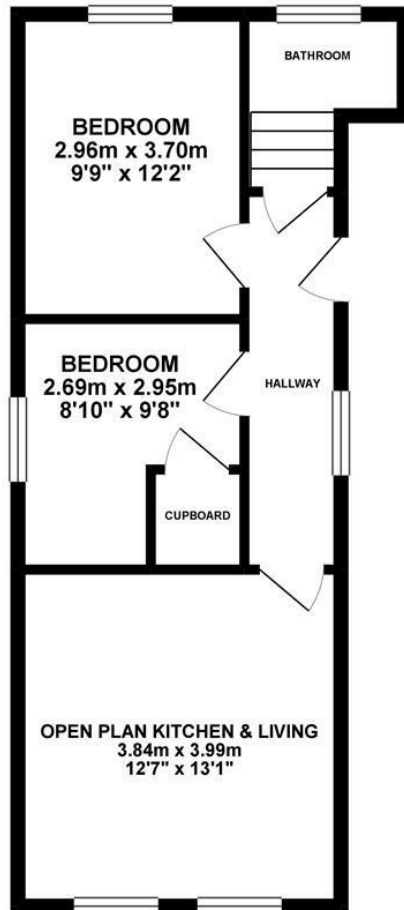

TOTAL FLOOR AREA : 41.43 sq. m. (445.96 sq. ft.) approx.

Whilst every attempt has been made to ensure the accuracy of the floorplan contained here, measurements of doors, windows, rooms and any other items are approximate and no responsibility is taken for any error, omission or mis-statement. This plan is for illustrative purposes only and should be used as such by any prospective purchaser. The services, systems and appliances shown have not been tested and no guarantee as to their operability or efficiency can be given.
Made with Matropix ©2019

