



Elphinstone Road, Hastings TN34 2FJ

£122,000



**** 40% SHARED OWNERSHIP **** a well presented three bedroom terraced house with allocated OFF ROAD PARKING located within a modern development in an enviable Blacklands location within easy reach of local schools, good transport links and St. Helens Woods. The accommodation here is arranged as a bright living room which enjoys a front aspect and a SEPARATE EAT-IN KITCHEN which is positioned at the rear of the property with access out to the landscaped garden. There is also a handy downstairs cloakroom and the under stairs cupboard has been transformed in to a STUDY AREA. On the first floor there are THREE BEDROOMS together with a family bathroom, the principal bedroom is fitted with BUILT-IN WARDROBES and relishes views across the Town to the English Channel. Externally the garden provides an area of patio which offers the perfect space to dine al-fresco with an expanse of lawn beyond and GATED SIDE ACCESS leading to the parking space. Being sold with NO ONWARD CHAIN this fantastic property would make the perfect first time home.

GROUND FLOOR
390 sq.ft. (36.3 sq.m.) approx.

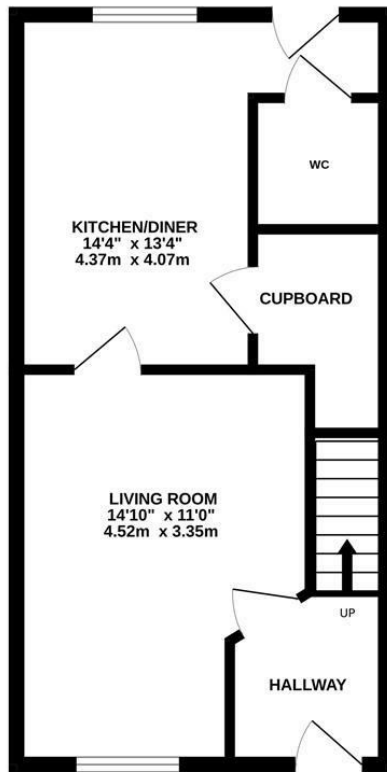

1ST FLOOR
390 sq.ft. (36.3 sq.m.) approx.

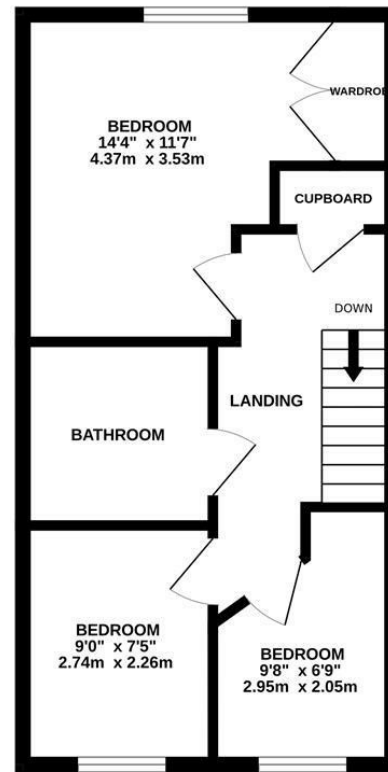

TOTAL FLOOR AREA : 781 sq.ft. (72.5 sq.m.) approx.

Whilst every attempt has been made to ensure the accuracy of the floorplan contained here, measurements of doors, windows, rooms and any other items are approximate and no responsibility is taken for any error, omission or mis-statement. This plan is for illustrative purposes only and should be used as such by any prospective purchaser. The services, systems and appliances shown have not been tested and no guarantee as to their operability or efficiency can be given.
Made with Metropix ©2025

