



Towerscroft Avenue, St. Leonards-On-Sea TN37 7JB

Offers in excess of £340,000



A deceptively spacious four bedroom SEMI-DETACHED HOUSE with OFF ROAD PARKING enviably placed within easy reach of local schools, good transport links, a range of shops and the Conquest Hospital, making this perfect for family life. Spanning two storeys the accommodation here is arranged as a BRIGHT LIVING ROOM, positioned at the rear of the property enjoying sliding doors leading to the CONSERVATORY which provides additional reception space and access to the rear garden while the MODERN FITTED KITCHEN/DINER is separate and offers ample storage. There is one double bedroom on this floor which benefits from an EN-SUITE SHOWER ROOM while the further three bedrooms can be found on the first floor together with a FAMILY BATHROOM where there is a bath and separate shower enclosure. The second bedroom also benefits from BUILT-IN WARDROBES. The rear garden offers a LARGE EXPANSE OF LAWN bordered by shrubs and trees while to the front of the property there is a DRIVEWAY providing off road parking for multiple vehicles making this the PERFECT FAMILY HOME.

GROUND FLOOR
705 sq.ft. (65.5 sq.m.) approx.

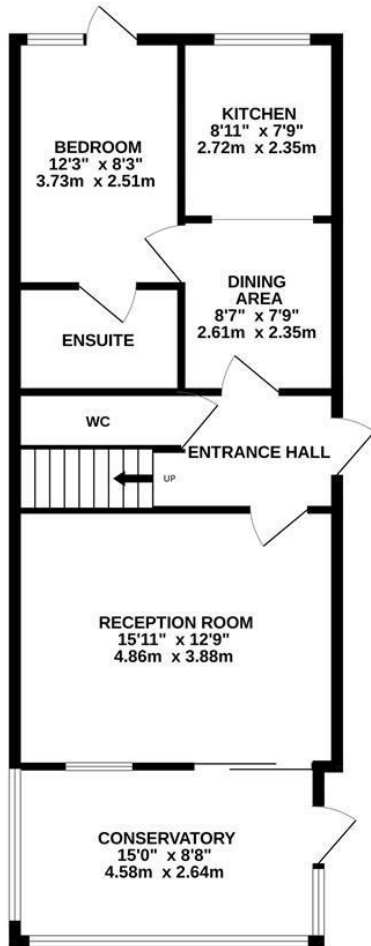

1ST FLOOR
467 sq.ft. (43.4 sq.m.) approx.

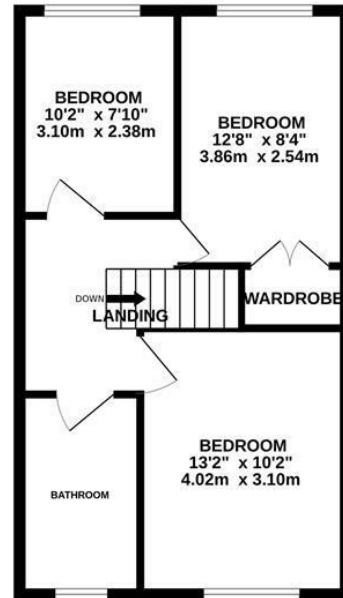

TOTAL FLOOR AREA: 1172 sq.ft. (108.9 sq.m.) approx.

Whilst every attempt has been made to ensure the accuracy of the floorplan contained here, measurements of doors, windows, rooms and any other items are approximate and no responsibility is taken for any error, omission or mis-statement. This plan is for illustrative purposes only and should be used as such by any prospective purchaser. The services, systems and appliances shown have not been tested and no guarantee as to their operability or efficiency can be given.
Made with Metropix ©2025

