



Dorset Place, Hastings TN34 1LG

Offers in excess of £225,000



An attractive DOUBLE FRONTED two bedroom house situated in an idyllic location just moments from the sea. It's enviably positioned within walking distance to Hastings Old Town, Hastings Town centre and the hub of St. Leonards On Sea where there are a range of local shops, easily accessible to both mainline railway stations and the seafront. The accommodation here is beautifully presented throughout and is arranged as a BRIGHT LIVING ROOM which features a WOOD BURNING STOVE while the MODERN FITTED KITCHEN is separate providing ample storage and access out to the REAR COURTYARD. There is also a handy storage cupboard and a BREAKFAST BAR, creating the ideal sociable setting. The first floor houses two bedrooms together with a stylish family bathroom where there is a bath with shower and screen over. Being sold with NO ONWARD CHAIN this fantastic property would make the perfect first time home or SEASIDE RETREAT.

GROUND FLOOR
236 sq.ft. (22.0 sq.m.) approx.

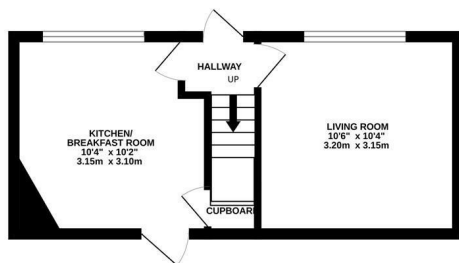

1ST FLOOR
239 sq.ft. (22.2 sq.m.) approx.

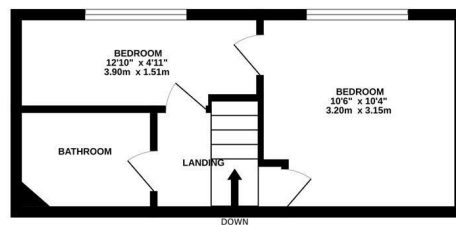

TOTAL FLOOR AREA : 476 sq.ft. (44.2 sq.m.) approx.

Whilst every attempt has been made to ensure the accuracy of the floorplan contained here, measurements of doors, windows, rooms and any other items are approximate and no responsibility is taken for any error, omission or mis-statement. This plan is for illustrative purposes only and should be used as such by any prospective purchaser. The services, systems and appliances shown have not been tested and no guarantee as to their operability or efficiency can be given.
Made with Metropix ©2025

