



The Lawn, St. Leonards-On-Sea TN38 0HH

Offers in excess of £200,000



BLOCK VIEWING- FRIDAY 31ST JANUARY BETWEEN 12:00-13:00. VIEWING BY APPOINTMENT ONLY

Idyllic two bedroom, grade II listed apartment set on the FIRST FLOOR of this stunning residence designed by DECIMUS BURTON. It's enviably located within an ATTRACTIVE CRESCENT which is SET AROUND PRIVATE RESIDENTS GARDENS, just a short stroll from the beach and the hub of St. Leonards On Sea with its artisan shops, eateries and the MAINLINE RAILWAY STATION with connections to London within 1 hour and 20 minutes. The accommodation here enjoys generous proportions with a CHARMING SOUTHERLY ASPECT LIVING SPACE which measures 14'10 x 14'1 relishing a FEATURE MARBLE SURROUND FIREPLACE and two large picture windows with a stunning VIEW TOWARDS THE SEA, there is a separate kitchen where there is plenty of storage space. To the rear of the property there are TWO BEDROOMS with

FIRST FLOOR
611 sq.ft. (56.7 sq.m.) approx.

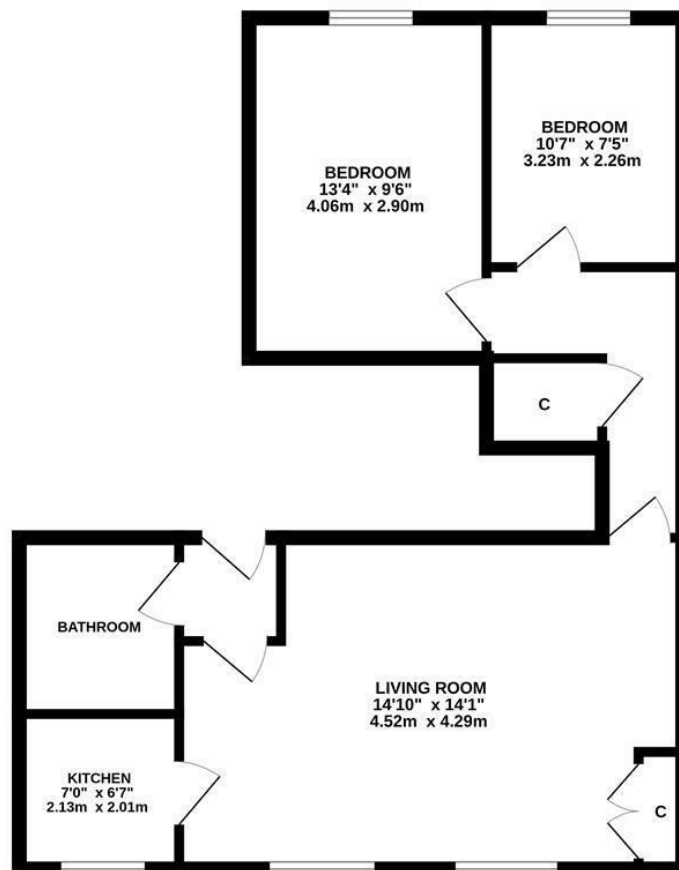

TOTAL FLOOR AREA : 611 sq.ft. (56.7 sq.m.) approx.

Whilst every attempt has been made to ensure the accuracy of the floorplan contained here, measurements of doors, windows, rooms and any other items are approximate and no responsibility is taken for any error, omission or mis-statement. This plan is for illustrative purposes only and should be used as such by any prospective purchaser. The services, systems and appliances shown have not been tested and no guarantee as to their operability or efficiency can be given.
Made with Metropix ©2023

