



Cornwallis Gardens, Hastings TN34 1LR

Offers in excess of £325,000



Exquisite two bedroom GARDEN APARTMENT set in an IDYLIC POSITION adjacent to Cornwallis Gardens and only a short stroll from the beach, shopping and leisure facilities in Hastings Town centre and the mainline railway station with connections to London. Spanning the HALL FLOOR of this IMPRESSIVE, DETACHED RESIDENCE the accommodation here is extremely well presented and boasts GRAND PROPORTIONS with a wealth of original features. There is a bright living room with a LARGE BAY WINDOW creating the perfect dining nook with an attractive outlook across the gardens. There is a separate kitchen/breakfast room where there is ample storage, PLENTY OF ROOM FOR A DINING TABLE and it's open to the SUN ROOM. There are TWO GENEROUS DOUBLE BEDROOMS along with a large family bathroom where there is a bath with a shower and screen over. The main bedroom also features an en-suite shower, a stunning rear facing bay window, BUILT-IN WARDROBES and access out to the garden. Externally there is a PRIVATE REAR GARDEN which is mainly laid to lawn with ascending tiers. Being sold with a SHARE OF FREEHOLD, long lease and NO ONWARD CHAIN this fantastic property is not to be missed.

HALL FLOOR
1114 sq.ft. (103.5 sq.m.) approx.

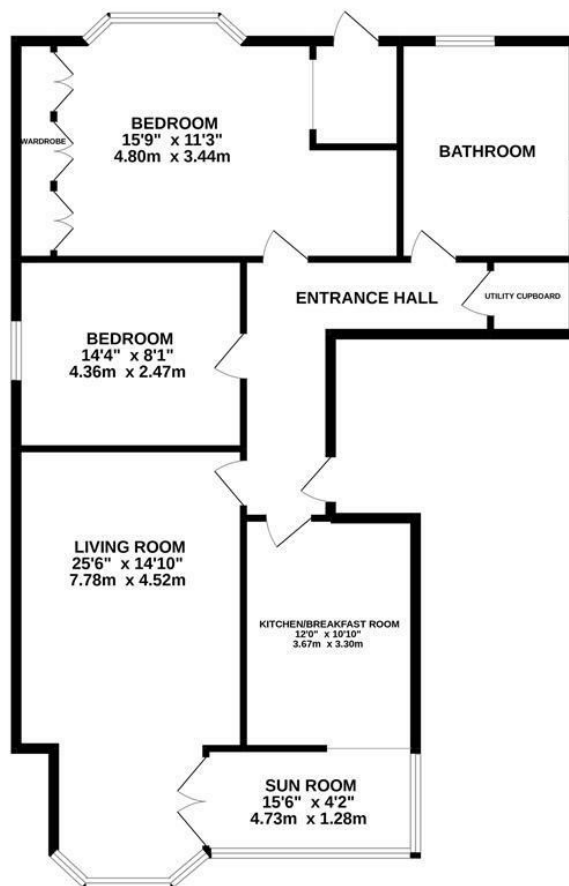

TOTAL FLOOR AREA - 1114 sq.ft. (103.5 sq.m.) approx.

Whilst every attempt has been made to ensure the accuracy of the floorplan contained here, measurements of doors, windows, rooms and any other items are approximate and no responsibility is taken for any error, omission or mis-statement. This plan is for illustrative purposes only and should be used as such by any prospective purchaser. The services, systems and appliances shown have not been tested and no guarantee as to their operability or efficiency can be given.

Made with Metropix ©2022

