



Marina, St. Leonards-On-Sea TN38 0BL

Offers in excess of £300,000



A beautifully presented TWO BEDROOM APARTMENT with STUNNING SEA VIEWS situated in an ideal seafront location sitting ADJACENT TO THE BEACH. It's just a short stroll from the hub of St. Leonards On Sea where you'll find local independent shops, award winning eateries and galleries, along with a mainline railway station with connections through to London. Spanning the GROUND FLOOR of this period block, the accommodation here relishes a WEALTH OF CHARACTER FEATURES including high ceilings, floor to ceiling sash windows and original wooden shutters. The apartment is arranged as a BRIGHT LIVING SPACE measuring an impressive 20'9 x 15'8 providing plenty of room for a full dining table and access to the SOUTH FACING BALCONY while the MODERN FITTED KITCHEN sits at the rear. There are SLIDING DOORS leading to the principle bedroom which enjoys a leafy rear aspect while the second bedroom can be found at the very rear together with a family bathroom where there is a bath with shower and screen over. Being sold with NO ONWARD CHAIN, this fantastic property would make the PERFECT SEASIDE RETREAT and is not to be missed.

GROUND FLOOR
860 sq.ft. (79.9 sq.m.) approx.

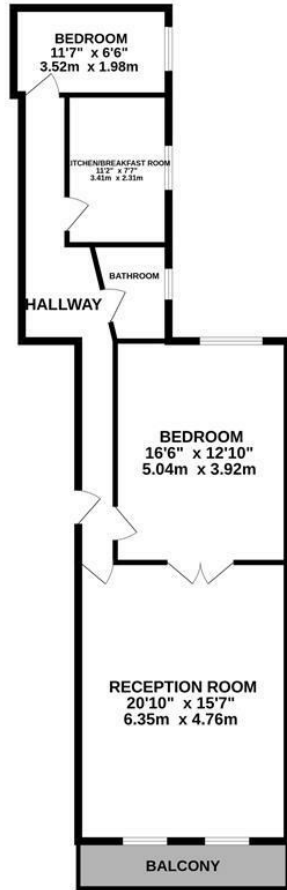

TOTAL FLOOR AREA : 860 sq.ft. (79.9 sq.m.) approx.

Whilst every attempt has been made to ensure the accuracy of the floorplan contained here, measurements of doors, windows, rooms and any other items are approximate and no responsibility is taken for any error, omission or mis-statement. This plan is for illustrative purposes only and should be used as such by any prospective purchaser. The services, systems and appliances shown have not been tested and no guarantee as to their operability or efficiency can be given.
Made with Metropix ©2024

